



Luscombe Maye
Since 1873

Windsor Court, Kingsbridge

£113,000

1 1 1

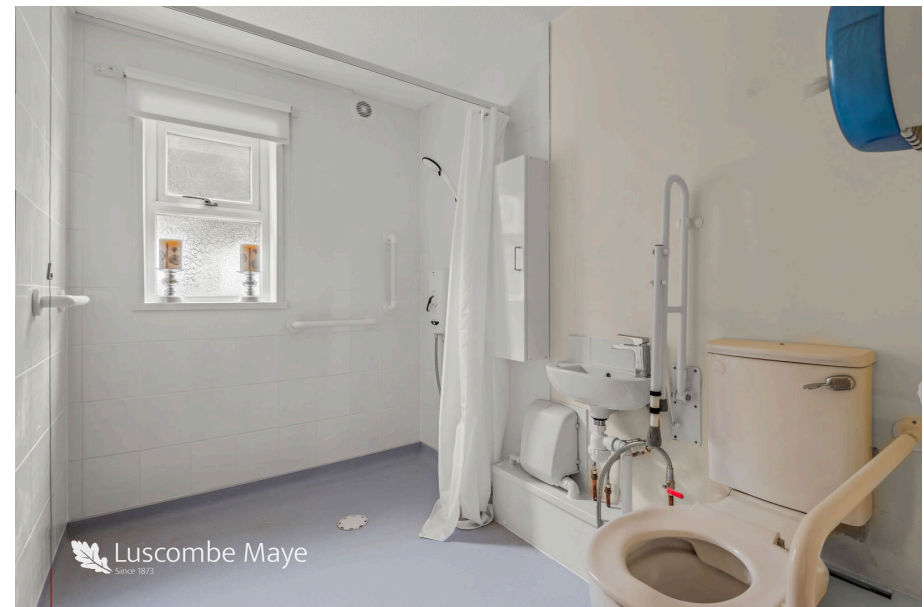

A beautifully presented, light and bright, one bedroom ground floor retirement apartment, situated in the heart of Kingsbridge. The apartment is part of a managed 60 plus retirement estate and enjoys a communal laundry room, beautifully maintained, communal gardens and ample unallocated parking.

Kingsbridge is a thriving South Hams town with a friendly and active local community and with excellent facilities including a leisure centre, cinema and highly rated schools. The town offers an ideal focal point to enjoy the exceptional coastline and local beaches and the peaceful Devon countryside, as well as being close to other popular towns such as Dartmouth, Totnes and Salcombe.

FURTHER INFORMATION

As part of our transparency policy, we request our sellers fill out a Property Information Questionnaire. This information can be provided to you. However, we recommend that you verify any information given during the conveyancing process.

SERVICES

Mains Water

Leasehold, 64 years remaining. Ground rent £100 per annum. Service charge £3166 per annum.

CONSTRUCTION

The property is understood to be a standard construction

PARKING

Communal Parking

TENURE

Leasehold, 64 years remaining. Ground rent £100 per annum. Service charge £3166 per annum.



12 Windsor Court Kingsbridge TQ7 1RZ

Approximate Gross Internal Floor Area = 32.0 sq m / 345 sq ft

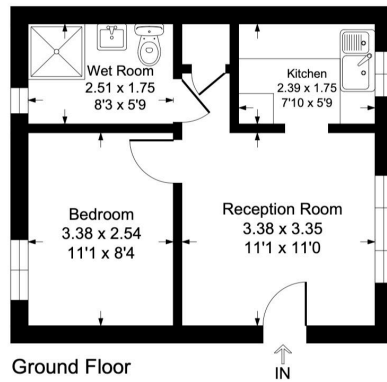

Illustration for identification purposes only, measurements are approximate, not to scale.

