



Luscombe Maye

Since 1873

Windsor Court, Kingsbridge

£119,000

🛏 1 🚿 1 🚻 1

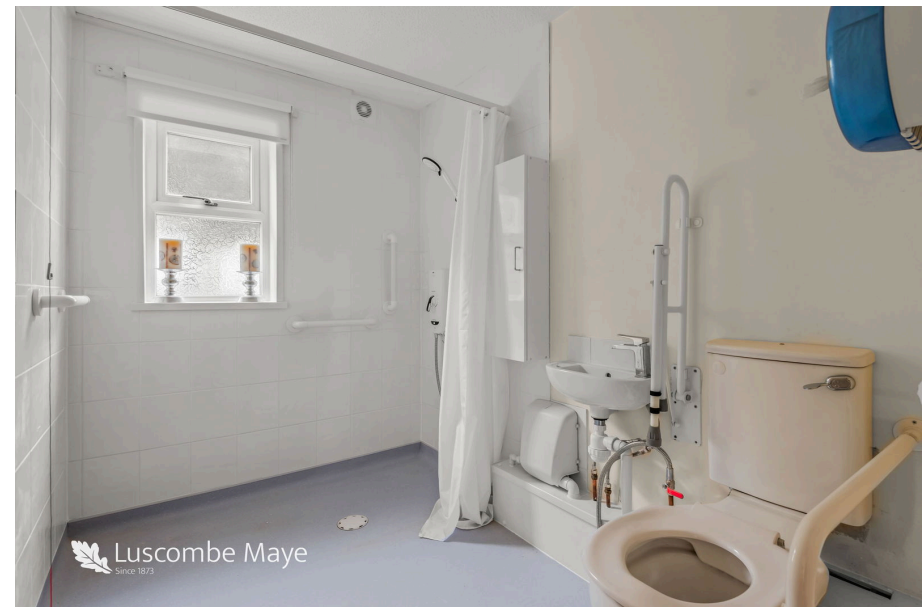

A beautifully presented, light and bright, one bedroom ground floor retirement apartment, situated in the heart of Kingsbridge. The apartment is part of a managed 60 plus retirement estate and enjoys a communal laundry room, beautifully maintained, communal gardens and ample unallocated parking.

Kingsbridge is a thriving South Hams town with a friendly and active local community and with excellent facilities including a leisure centre, cinema and highly rated schools. The town offers an ideal focal point to enjoy the exceptional coastline and local beaches and the peaceful Devon countryside, as well as being close to other popular towns such as Dartmouth, Totnes and Salcombe.

FURTHER INFORMATION

As part of our transparency policy, we request our sellers fill out a Property Information Questionnaire. This information can be provided to you. However, we recommend that you verify any information given during the conveyancing process.

SERVICES

Electric: mains

Water: Mains

Drainage: Mains

Heating: Electric

CONSTRUCTION

The property is understood to be a standard construction

PARKING

Communal Parking

TENURE

Leasehold, 64 years remaining. Ground rent £100 per annum. Service



12 Windsor Court Kingsbridge TQ7 1RZ

Approximate Gross Internal Floor Area = 32.0 sq m / 345 sq ft

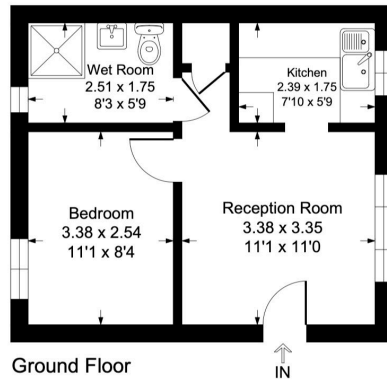
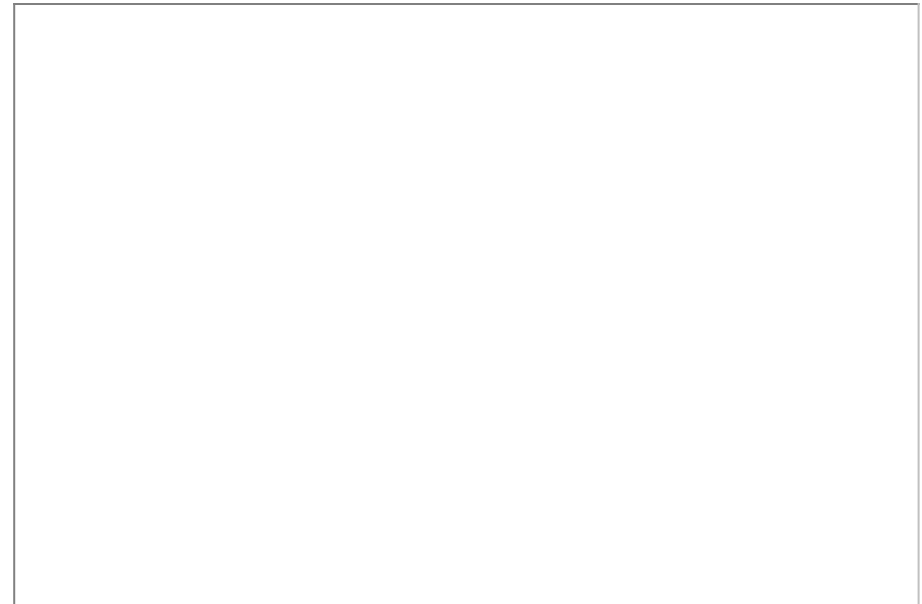

Illustration for identification purposes only, measurements are approximate, not to scale.



Important Notice: Luscombe Maye gives notice that: 1. These particulars do not constitute an offer or contract or part thereof. 2. All descriptions, photographs and plans are for guidance only and should not be relied upon as statements or representations of fact. All measurements are approximate and not necessarily to scale. Any prospective purchaser must satisfy themselves of the correctness of the information within the particulars by inspection or otherwise. 3. Luscombe Maye does not have any authority to give any representations or warranties whatsoever in relation to this property (including but not limited to planning/building regulations), nor can it enter into any contract on behalf of the Vendor.



Kingsbridge:
62 Fore Street, Kingsbridge TQ7 1PP
01548 857474
kingsbridge@luscombemaye.com
www.luscombemaye.com