

Paul Mason Associates



North Drive, Mayland, Essex, CM3 6AG

Offers over £650,000



## Accommodation

### GROUND FLOOR

Entrance Hall

Inner Hall

Kitchen/Breakfast/Sitting Room

9.66m x 3.56m (31'8" x 11'8")

Lounge

5.31m x 5.05m (17'5" x 16'6")

Sitting Room

4.51m x 3.48m (14'9" x 11'5")

Bathroom

Bedroom

3.63m x 2.78m (11'10" x 9'1")

Bedroom

3.62m x 2.61m (11'10" x 8'6" )

Snug/Study

2.67m x 2.56m (8'9" x 8'4")

Bedroom

4.27m x 3.36m (14'0" x 11'0")

Ensuite

### FIRST FLOOR

Landing

Bedroom One

5.66m x 3.46m (18'6" x 11'4")

Ensuite

### EXTERIOR

Rear Garden 104' x 50'

Home Office/Games Room

6.19m x 3.62m (20'3" x 11'10")

Side Garden

Courtyard Garden

Front Garden

Services

Gas- Mains

Electric- Mains

Water- Mains

Drainage- Mains

Heating- Gas

Local Authority - Maldon District

Council

Viewings.

Strictly by appointment only through the selling agent Paul Mason Associates on 01621 742310.

Important Notices.

We wish to inform all prospective purchasers that we have prepared these particulars including text,

photographs and measurements as a general guide. Room sizes should not be relied upon for carpets and furnishings. We have not carried out a survey or tested the services, appliances and specific fittings. These particulars do not form part of a contract and must not be relied upon as statement or representation of fact.

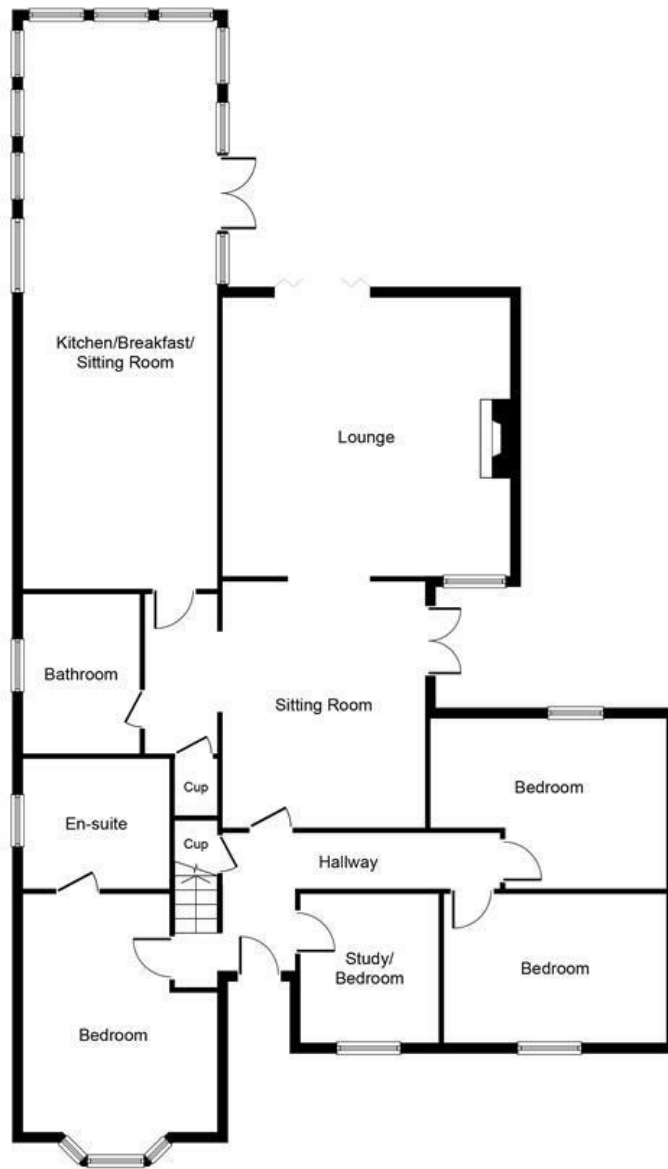

**Ground Floor**



**First Floor**



Paul Mason Associates

35 The Street  
Latchingdon  
Chelmsford  
Essex  
CM3 6JP

T: 01621 742 310

Bruce House  
17 The Street  
Hatfield Peverel  
Chelmsford  
CM3 2DP

T: 01245 382 555

Sales | Lettings | Development | Investment

F: 01245 381257 E: [info@paulmasonassociates.co.uk](mailto:info@paulmasonassociates.co.uk) [www.paulmasonassociates.co.uk](http://www.paulmasonassociates.co.uk)

Paul Mason Associates Limited Registered in England Number - 6767946  
Registered Office - Bruce House, The Street, Hatfield Peverel CM3 2DP





Paul Mason Associates

35 The Street  
Latchingdon  
Chelmsford  
Essex  
CM3 6JP

T: 01621 742 310

Bruce House  
17 The Street  
Hatfield Peverel  
Chelmsford  
CM3 2DP

T: 01245 382 555

Sales | Lettings | Development | Investment

F: 01245 381257 E: [info@paulmasonassociates.co.uk](mailto:info@paulmasonassociates.co.uk) [www.paulmasonassociates.co.uk](http://www.paulmasonassociates.co.uk)

Paul Mason Associates Limited Registered in England Number - 6767946  
Registered Office - Bruce House, The Street, Hatfield Peverel CM3 2DP





Paul Mason Associates

35 The Street  
Latchingdon  
Chelmsford  
Essex  
CM3 6JP

T: 01621 742 310

Bruce House  
17 The Street  
Hatfield Peverel  
Chelmsford  
CM3 2DP

T: 01245 382 555

Sales | Lettings | Development | Investment

F: 01245 381257 E: [info@paulmasonassociates.co.uk](mailto:info@paulmasonassociates.co.uk) [www.paulmasonassociates.co.uk](http://www.paulmasonassociates.co.uk)

Paul Mason Associates Limited Registered in England Number - 6767946  
Registered Office - Bruce House, The Street, Hatfield Peverel CM3 2DP





Paul Mason Associates

35 The Street  
Latchingdon  
Chelmsford  
Essex  
CM3 6JP  
T: 01621 742 310

Bruce House  
17 The Street  
Hatfield Peverel  
Chelmsford  
CM3 2DP  
T: 01245 382 555

Sales | Lettings | Development | Investment

F: 01245 381257 E: info@paulmasonassociates.co.uk www.paulmasonassociates.co.uk

Paul Mason Associates Limited Registered in England Number - 6767946  
Registered Office - Bruce House, The Street, Hatfield Peverel CM3 2DP

