



Weir Road, SW12

£1,550 Per calendar month

A ground floor, one bedroom flat with two private terraces. Offering a spacious reception room, a separate kitchen, a double bedroom, storage space and a bathroom with a separate WC.

Situated in the heart of Balham and ideally located for Balham station, offering mainline services to London Victoria, London Bridge and underground services into the City and West End. There is an array of local shops, wine bars and restaurants nearby.

Features

- Ground Floor Flat
- One Double Bedroom
- Reception Room
- Separate Kitchen
- Bathroom And WC
- Nearby Transport Links

Weir Road, London, SW12

Ground Floor

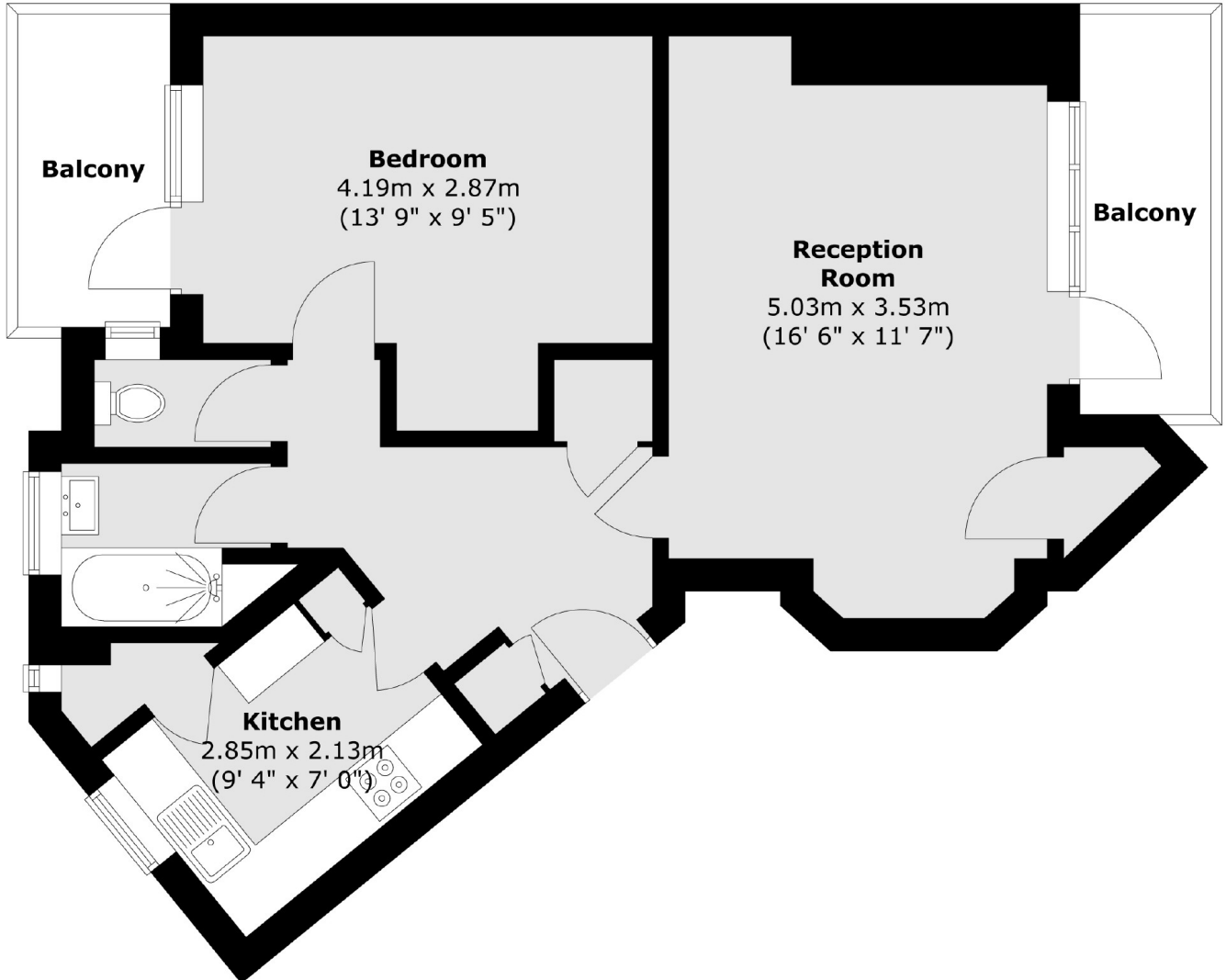

Total area (approx.) : 53.3 sq. m (574 sq. ft)
Total balcony area (approx.) : 7.3 sq. m (78 sq. ft)