



Rodenhurst Road, SW4

£1,850 Per calendar month

A one bedroom ground floor flat with a communal garden. Offering a reception room, a separate galley kitchen, a double bedroom with built-in wardrobes and wooden flooring throughout. Ideal for a professional couple.

One of Clapham's most desirable residential streets. You have Abbeville Road with its many boutique shops, restaurants and cafés, along with Clapham Common station close by.

Features

- One Double Bedroom
- Ground Floor Flat
- Reception Room
- Separate Kitchen
- Wooden Flooring
- Communal Garden

Rodenhurst Road, London, SW4

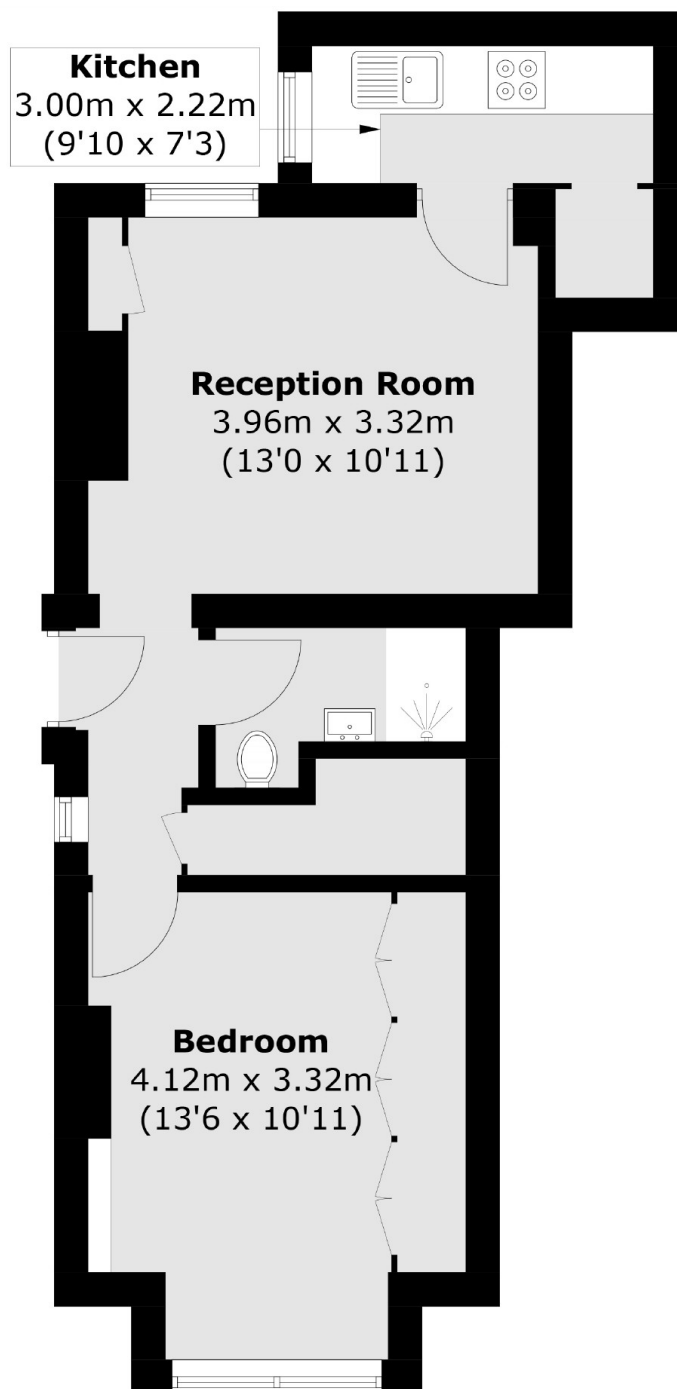

Total area (approx.): 40.0 sq. m (430.6 sq. ft)