



## Poynders Gardens, SW4

£3,600 Per calendar month

A well-presented four bedroom purpose built flat with a private balcony, open plan kitchen and reception room, a bathroom with separate W.C and access to communal gardens. Ideal for professional sharers.

The property is located near the many amenities found in Clapham South and Balham. Clapham South tube station and Clapham Common itself are also close by.

### Features

- Four Bedrooms
- Modern Kitchen
- Open Plan Reception
- Private Balcony
- Wooden Flooring
- Communal Gardens

# Poynders Gardens, London, SW4

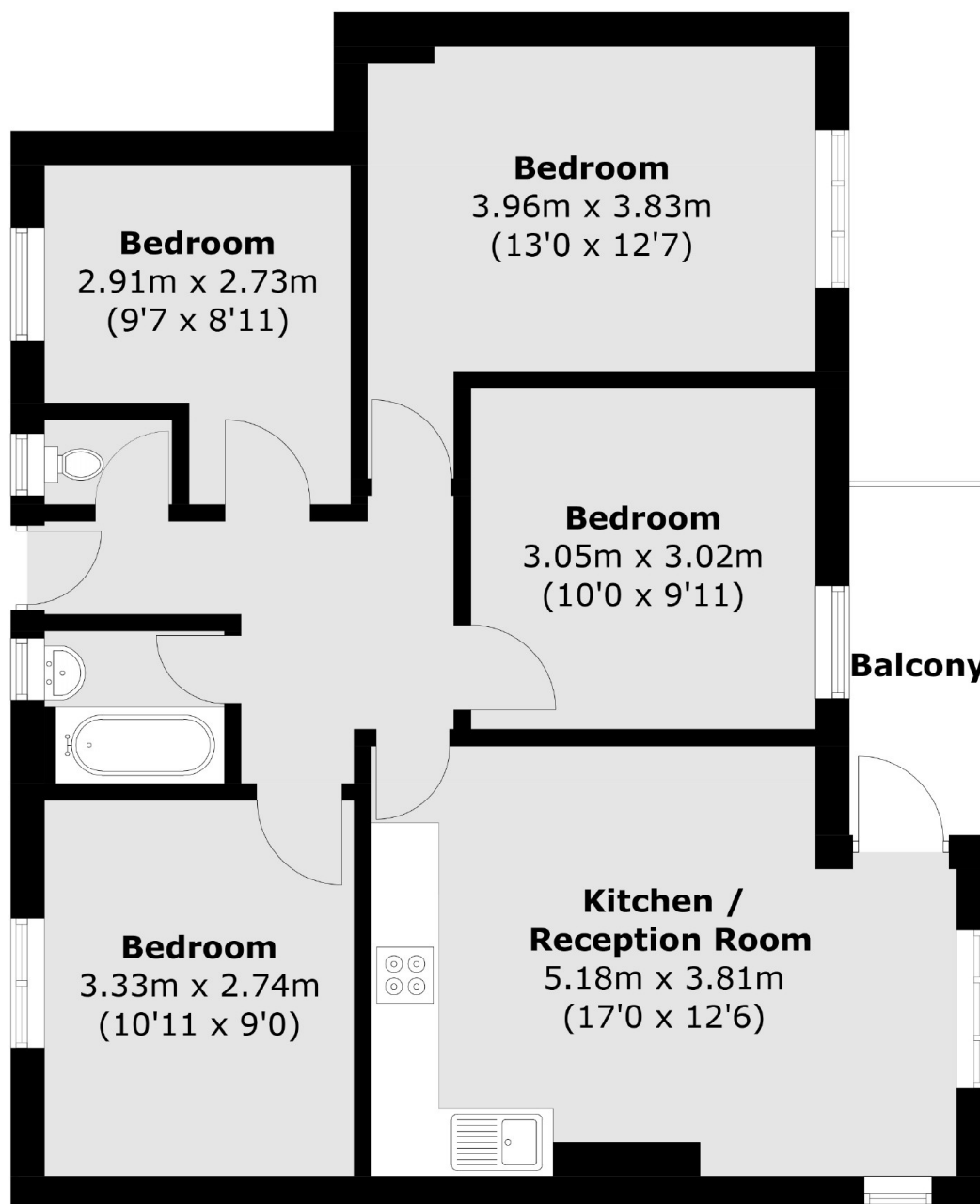

Total area (approx.): 68.9 sq. m (741.6 sq. ft)  
Balcony area : 3.7 sq. m (39.8 sq. ft)