

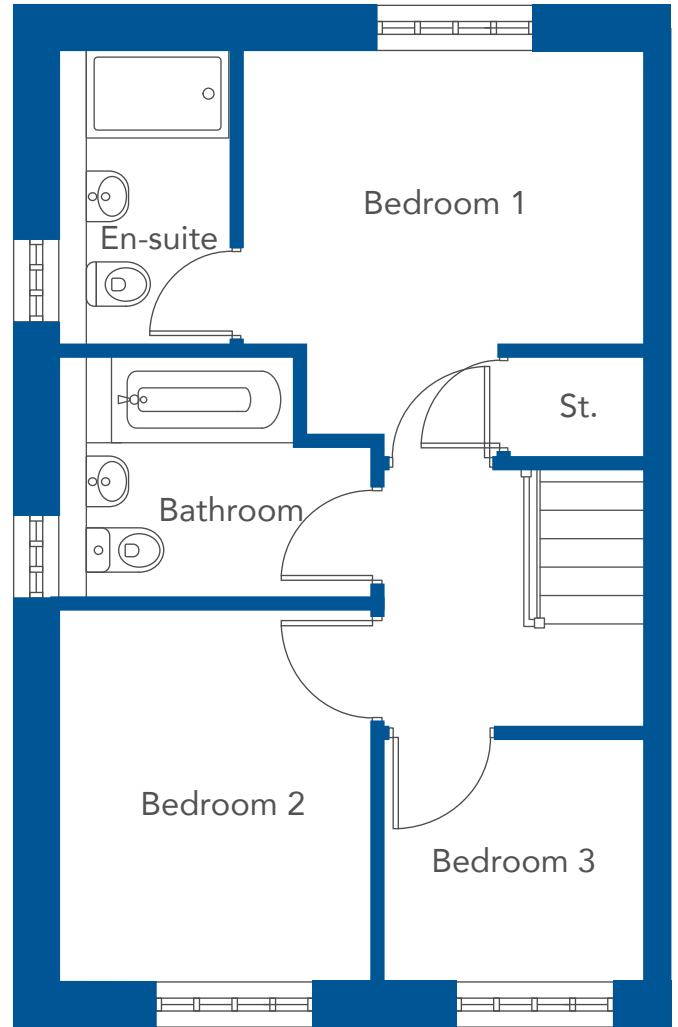

BARTON QUARTER THE TAILOR

- 3 bedrooms
- 2 bathrooms
- Security Alarm
- Outside tap
- Laminate flooring to the downstairs
- Carpets to the stairs and bedrooms
- Contemporary neutral bathroom suites
- Modern appliances and white goods included
 - fridge freezer, washing/drying machine, dishwasher, integrated oven and hob
- Blinds to the front of the property and to all bedrooms
- Fitted mirrored wardrobe in the main bedroom
- French doors
- White internal doors
- Stylish kitchen units and worktops
- Patio and garden
- Driveway offering off-road parking
- All properties internally wired to connect to phone, internet, and TV providers

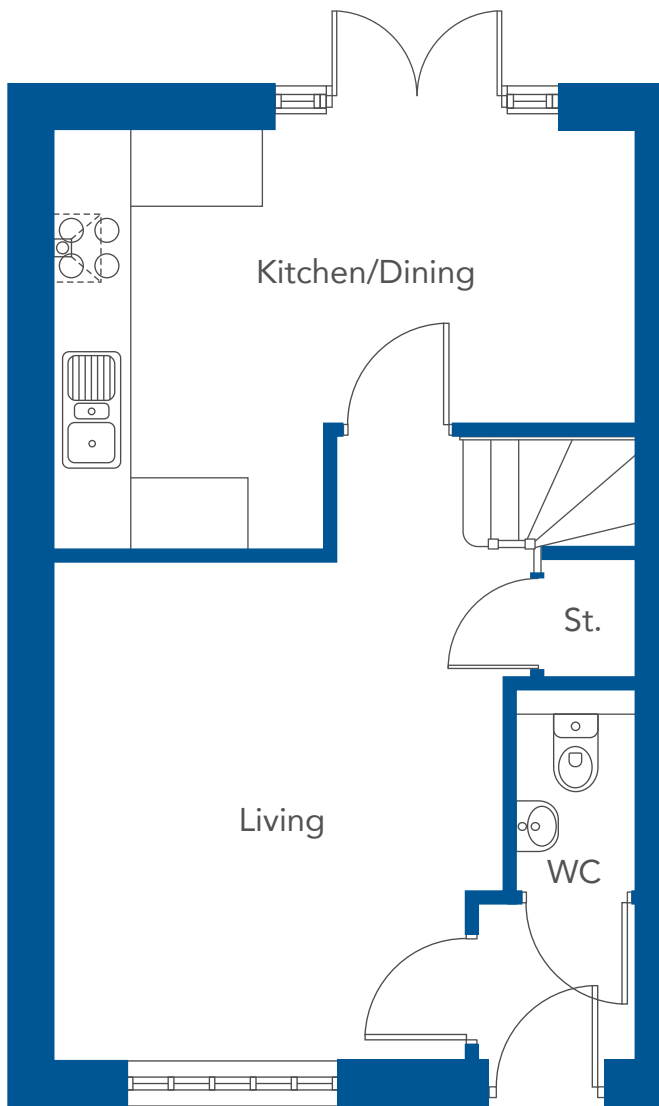

THE TAILOR

Living

3.72x4.15m (12' 2"x13' 7")*

Kitchen/Dining

4.83x3.49m (15' 10"x11' 5")†

Bedroom 1

3.33x2.47m (10' 11"x8' 1")

En-suite

1.44x2.47m (4'9"x8'1")

Bedroom 2

2.56x3.12m (8' 5"x10' 3")

Bedroom 3

2.20x2.07m (7' 3"x6' 10")

Bathroom

2.56x1.99m (8' 5"x6' 6")†

These measurements may vary slightly by plot. The external elevations, architectural detailing and floor plans of individual house types may vary from those illustrated. All room sizes are approximate with maximum dimensions. While every effort has been made to ensure that the information contained in this leaflet is correct, it is designed specifically as a guide and we reserve the right to amend the specifications as necessary and without notice. These particulars do not wholly or in part constitute a contract or agreement and are for general guidance only. Images are indicative only. * Denotes longest measurement taken. † Denotes some shortest measurements taken. ‡ Denotes general measurements taken.