

CARDIFF'S HOME FOR  
STYLISH SALES  
& LETTINGS

JeffreyRoss

BUTE TERRACE  
CITY CENTRE











## BUTE TERRACE

CITY CENTRE, CF10 2FP - £1,500  
PCM



1 Bedroom(s)



1 Bathroom(s)



540.00 sq ft

A modern one bedroom property that has been recently refurbished to an excellent standard. The property is furnished and is situated in the heart of the City Centre in the ever popular Meridian Plaza development, directly opposite John Lewis, the Hayes and just a 5 minute walk to Cardiff Central Train Station. The apartment briefly comprises of large lounge, modern fully fitted kitchen including a dishwasher, one double bedroom with fitted wardrobes, stylish bathroom with a shower and underfloor heating. The water rates are not included. 24 hour concierge. Parking options available - ask agent.

EPC RATING of C.  
COUNCIL TAX BAND of D.

A holding fee of one weeks' rent will be payable to secure the dwelling. This will be deducted from the final balance payable upon moving into the dwelling, subject to a successful application. Jeffrey Ross Limited reserves the right to retain this payment should the applicant have provided false or misleading information at the time of applying for the dwelling or failed to take reasonable steps to enter into the Standard Occupation Contract.

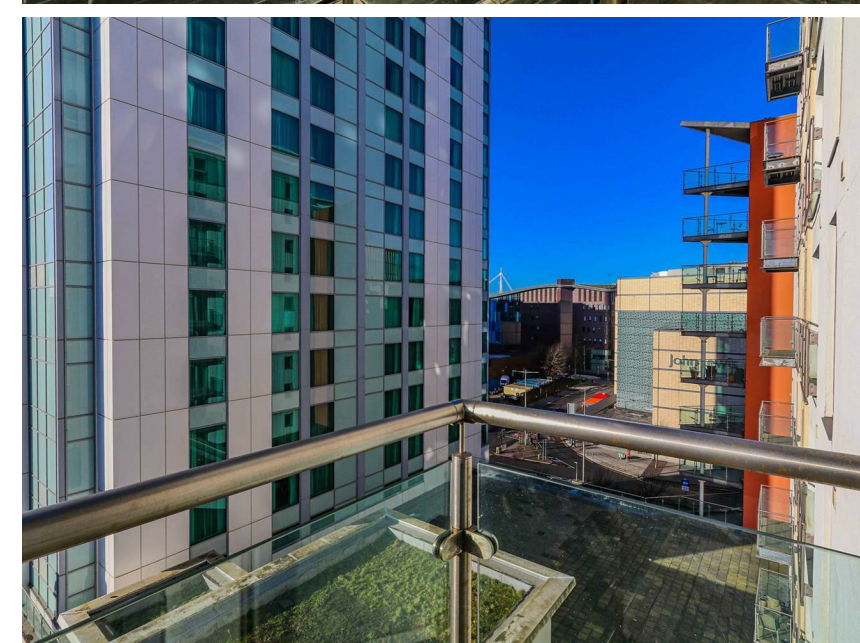
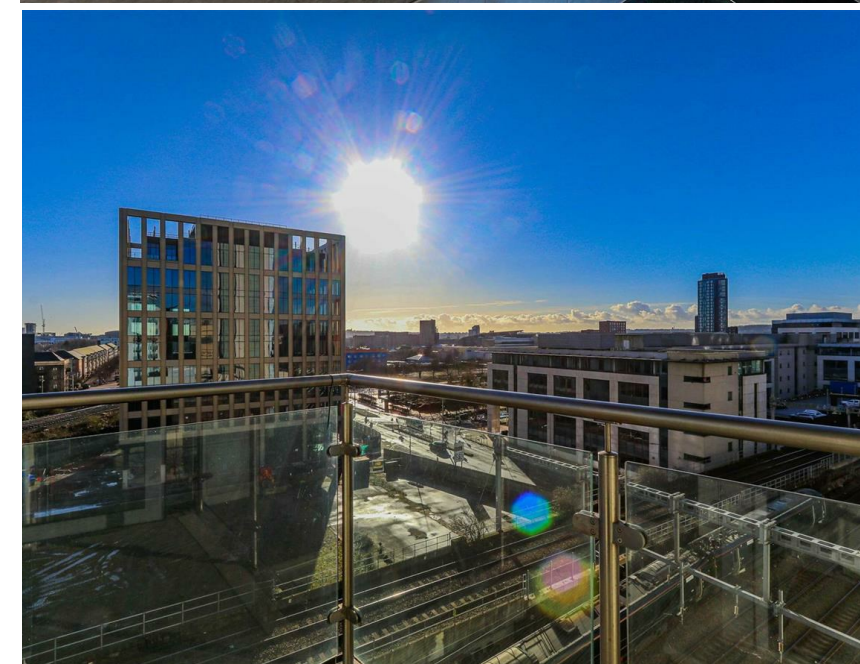

### PROPERTY SPECIALIST

Mr Rhys Carter  
rhys.carter@jeffreygross.co.uk  
Lettings





Meridian Plaza, City Centre



Total Area: 50.2 m² ... 540 ft² (excluding balcony)  
All measurements are approximate and for display purposes only

| Energy Efficiency Rating                    |                         |           |
|---|-------------------------|-----------|
|   | Current                 | Potential |
| Very energy efficient - lower running costs |                         |           |
| (92 plus) A                                 |                         |           |
| (81-91) B                                   |                         |           |
| (69-80) C                                   |                         |           |
| (55-68) D                                   |                         |           |
| (39-54) E                                   |                         |           |
| (21-38) F                                   |                         |           |
| (1-20) G                                    |                         |           |
| Not energy efficient - higher running costs |                         |           |
| England & Wales                             | EU Directive 2002/91/EC |           |