

CARDIFF'S HOME FOR
STYLISH SALES
& LETTINGS

JeffreyRoss



NEWPORT ROAD
ROATH





NEWPORT ROAD

ROATH, CF24 1RN - £5,000 PCM

 14 Bedroom(s)
  14 Bathroom(s)
  6509.00 sq ft

Superb opportunity to acquire this extremely spacious commercial premises in a prime, central location that would be perfect for multi-usage and would make a prime administration centre or an ideal option in the healthcare sector. This substantial site is located over 2 floors and occupies circa 6300 square feet and offers a host of benefits to include:-

- 14 rooms
- Parking for up to 12 vehicles
- Segregated rooms which could offer multi-usage
- Just over 1 mile from Cardiff City Centre
- Two levels
- Set across a number of terraced houses

Flexible terms / spaces are available to please contact Jon at JeffreyRoss on 02920499680 or email jon@jeffreycross.co.uk if you have any queries.

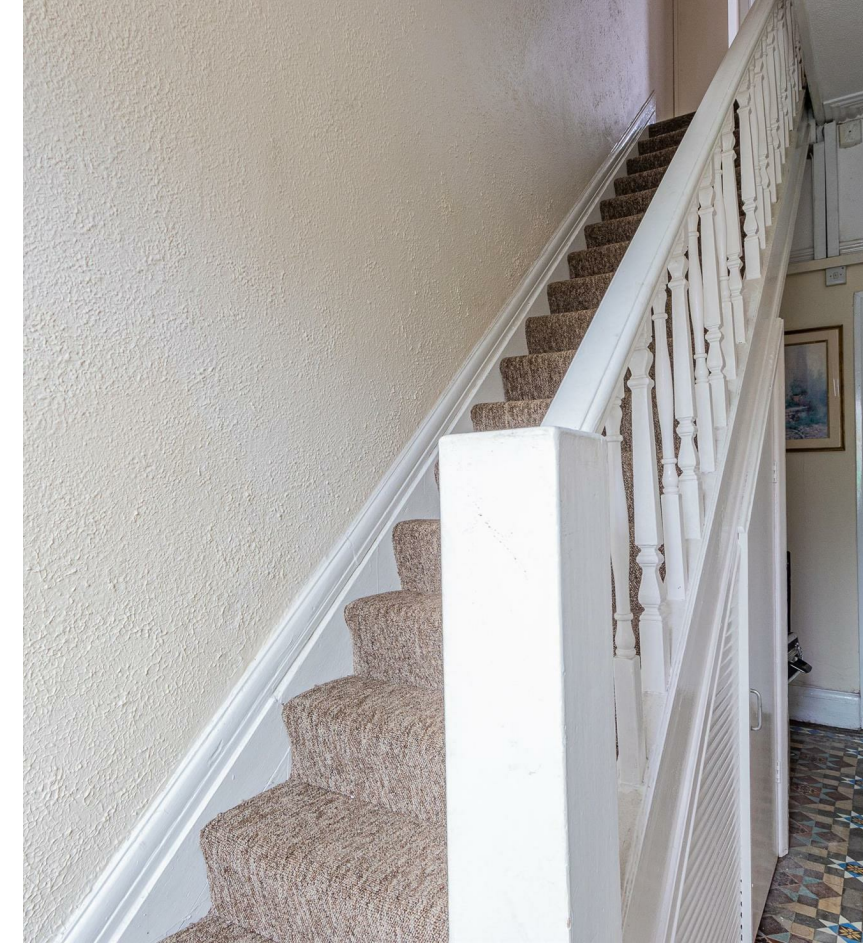

PROPERTY SPECIALIST

Jon Hooper-Nash
jon@jeffreycross.co.uk
 Director





Energy Efficiency Rating		
	Current	Potential
Very energy efficient - lower running costs		
(92 plus) A		
(81-91) B		
(69-80) C		
(55-68) D		
(39-54) E		
(21-38) F		
(1-20) G		
Not energy efficient - higher running costs		
England & Wales		EU Directive 2002/91/EC