

CARDIFF'S HOME FOR
STYLISH SALES
& LETTINGS

JeffreyRoss



NEWPORT ROAD
ROATH





NEWPORT ROAD

ROATH, CF24 1DP - £925 PCM

 1 Bedroom(s)  1 Bathroom(s)  sq ft

A charming, first-floor, one bedroom apartment in this purpose built block. The apartment is within walking distance to the City Centre and Roath amenities. This property comprises, large living space, separate fitted kitchen, large family bathroom, 1 double bedroom and is furnished. George Court further boasts private parking to the rear.

EPC RATING of B
COUNCIL TAX BAND of B.

A holding fee of one weeks' rent will be payable to secure the property. This will be deducted from the final balance payable upon moving into the property, subject to a successful application. JeffreyRoss Limited reserves the right to retain this payment should the applicant have provided false or misleading information at the time of applying for the Tenancy or failed to take reasonable steps to enter into the tenancy agreement



PROPERTY SPECIALIST
Mr Rhys Carter
rhys.carter@jeffreyyross.co.uk
Lettings





George Court, Roath

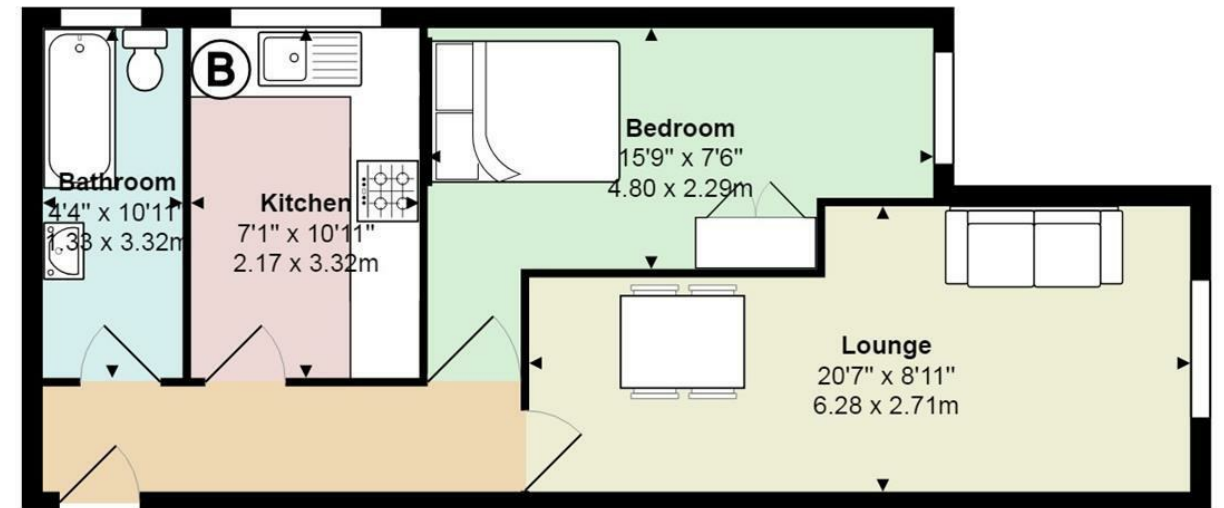

Total Area: 472 ft² ... 43.8 m²

All measurements are approximate and for display purposes only

| Energy Efficiency Rating | | |
|---|---|-----------|
| | Current | Potential |
| Very energy efficient - lower running costs | | |
| (92 plus) A | | |
| (81-91) B | 83 | 86 |
| (69-80) C | | |
| (55-68) D | | |
| (39-54) E | | |
| (21-38) F | | |
| (1-20) G | | |
| Not energy efficient - higher running costs | | |
| England & Wales | EU Directive 2002/91/EC  | |