

CARDIFF'S HOME FOR  
STYLISH SALES  
& LETTINGS

JeffreyRoss



CHURCHILL WAY  
CITY CENTRE





## CHURCHILL WAY

CITY CENTRE, CF10 2EA - £950 PCM

 1 Bedroom(s)  1 Bathroom(s)  sq ft

In the heart of the City Centre, on Churchill Way is an exciting selection of apartments that are brand new for 2019. Apartment 20 is a first-floor one bedroom apartment that offers open-plan lounge kitchen with laminate flooring throughout, IKEA furniture and neutral decoration. A large double bedroom is offered with double bed, wardrobe and chest of drawers and the property is completed by stylish bathroom suite with bathtub and shower over. There is unfortunately no parking available within this development.

Council Tax Band D  
EPC Rating D

A holding fee of one weeks' rent will be payable to secure the property. This will be deducted from the final balance payable upon moving into the property, subject to a successful application. Jeffrey Ross Limited reserves the right to retain this payment should the applicant have provided false or misleading information at the time of applying for the Tenancy or failed to take reasonable steps to enter into the tenancy agreement.



### PROPERTY SPECIALIST

Miss Lauren King  
lauren.king@jeffreycross.co.uk  
02920499680  
Lettings Negotiator



## Churchill Villas, City Centre

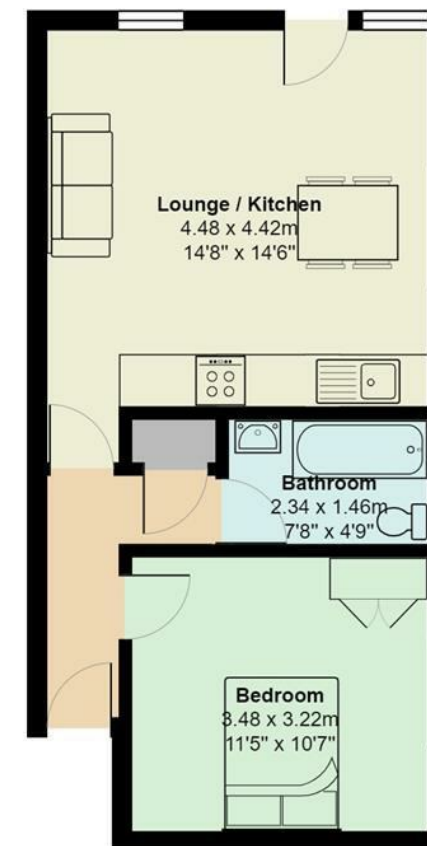

Total Area: 40.9 m<sup>2</sup> ... 440 ft<sup>2</sup>

All measurements are approximate and for display purposes only

Energy Efficiency Rating		
	Current	Potential
<i>Very energy efficient - lower running costs</i>		
(92 plus) <b>A</b>		
(81-91) <b>B</b>		
(69-80) <b>C</b>		
(55-68) <b>D</b>		
(39-54) <b>E</b>		
(21-38) <b>F</b>		
(1-20) <b>G</b>		
<i>Not energy efficient - higher running costs</i>		
<b>England &amp; Wales</b>	EU Directive 2002/91/EC	