

CARDIFF'S HOME FOR
STYLISH SALES
& LETTINGS

JeffreyRoss



MARYPORT ROAD
LAKESIDE

MARYPORT ROAD

LAKESIDE, CF23 5JX - £917 PCM PCM

0 bedroom(s) 0 bathroom(s) 753.00 sq ft

Great opportunity to acquire this ground-floor space within walking distance of Roath Park. Comprising roughly 750 square feet of ground-floor accommodation, the we are advised property has A3 use and is currently setup as a coffee and sandwich shop.

Parking options to the front and within a short stroll of Roath Lake - a great location and a brilliant space.

Call Jon in our Roath office for more information on 02920499680.



Energy Efficiency Rating		
	Current	Potential
<i>Very energy efficient - lower running costs</i>		
(92 plus) A		
(81-91) B		
(69-80) C		
(55-68) D		
(39-54) E		
(21-38) F		
(1-20) G		
<i>Not energy efficient - higher running costs</i>		
England & Wales	EU Directive 2002/91/EC	

PROPERTY SPECIALIST

Jon Hooper-Nash
jon@jeffreycross.co.uk



Director

Maryport Road, Lakeside

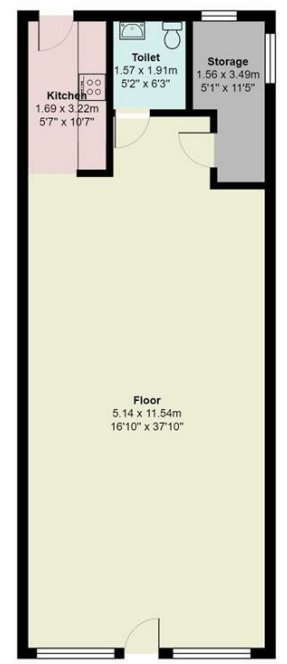

Total Area: 70.0 m² ... 753 ft²
All measurements are approximate and for display purposes only.