



17B SILVERDALE GARDENS

LARGS

www.corumproperty.co.uk



1 | BEDROOM
1 | BATHROOM
1 | PUBLIC ROOM

This ground floor flat is located in this popular address which is in close proximity to the town centre and Largs local amenities. The property does require a degree of modernisation.

- Ground floor flat
- Close to town centre & local amenities
- Good sized lounge
- Dining Kitchen
- Double bedroom
- Shower room
- Gas Central Heating
- Double Glazing

Amenities

Largs is a popular holiday destination and is becoming increasingly popular for those looking for a seaside home in a town with a good range of amenities and recreational facilities. The Largs Academy Campus (built 2018) incorporates Early Years Learning, Largs Primary and St Mary's Primary as well as the highly regarded Largs Academy. Inverclyde, Scotland's National Sport's centre has also recently been refurbished. The area has excellent travel links including Largs railway station, bus routes and easy access to the major road networks. There are many restaurants and hotels in the area, with the yacht marina and seafront being an attraction for many. Prestwick and Glasgow Airport offer regular flights throughout Britain, Ireland and Europe.



Ground Floor

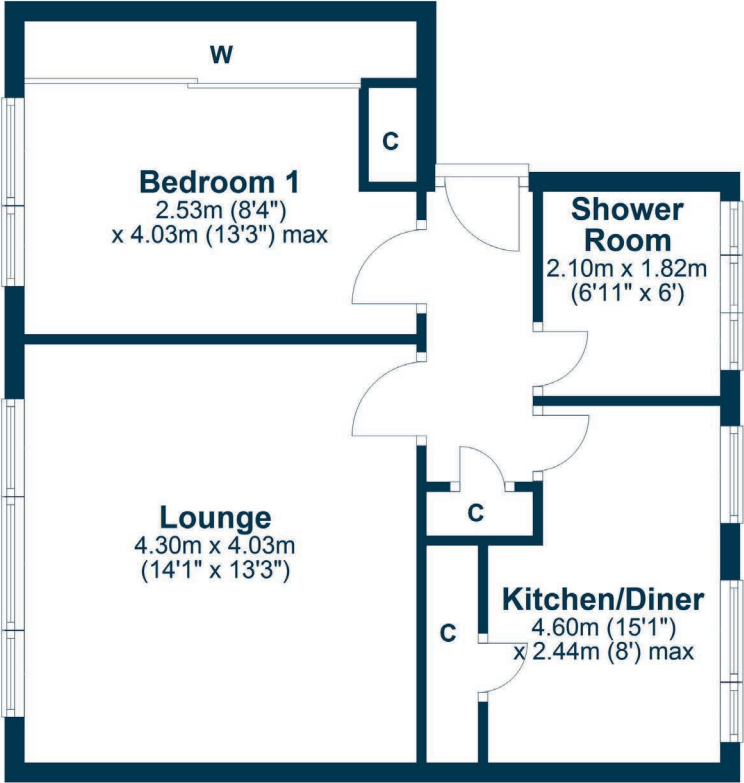

Sat Nav:
17B Silverdale Gardens, KA30 9LT

LA2072

*All measurements and distances are approximate.
Floorplans are for illustration purposes and may not be to scale.

For the full home report visit
www.corumproperty.co.uk



WE'RE **SOLD** ON
YOUR FUTURE



Corum Largs
66 Main Street, Largs, KA30 8AL

Tel: 01475 675 001

Email: largs@corumproperty.co.uk

www.corumproperty.co.uk