



Sefton Crescent, Sale, Trafford, M33

Guide Price: £290,000

Freehold

Sefton Crescent, Sale, Trafford, M33

**** OFFERED WITH NO ONWARD CHAIN **** This two bedroom mid-terrace home is located on Sefton Crescent, just a short walk from Sale town centre. Offered with no onward chain, this property presents a fantastic opportunity for first-time buyers or professional couples looking to put their own stamp on a home.

The property features a spacious living room with patio doors that open out to the rear garden, allowing for plenty of natural light and easy access to outdoor space. The fitted kitchen provides a practical layout, offering ample storage and workspace.

Upstairs, you will find two generously sized bedrooms, perfect for a growing family, guests, or home office use. The four-piece bathroom suite includes a bathtub and separate shower, adding convenience and versatility.

Externally, the home benefits from off-road parking to the front, while the enclosed rear garden offers a paved patio and a lawn area, ideal for outdoor entertaining or relaxing.

Situated in a highly sought-after location, this property is just a short stroll from Sale town centre, offering a fantastic selection of shops, cafes, and restaurants. The area is well-connected with excellent transport links, including the Metrolink, providing easy access to Manchester city centre and beyond. For those who enjoy outdoor activities, the nearby Bridgewater Canal and local parks, such as Worthington Park, provide beautiful settings for walking, cycling, and relaxing. This prime location combines convenience with a tranquil environment, making it perfect for modern living.

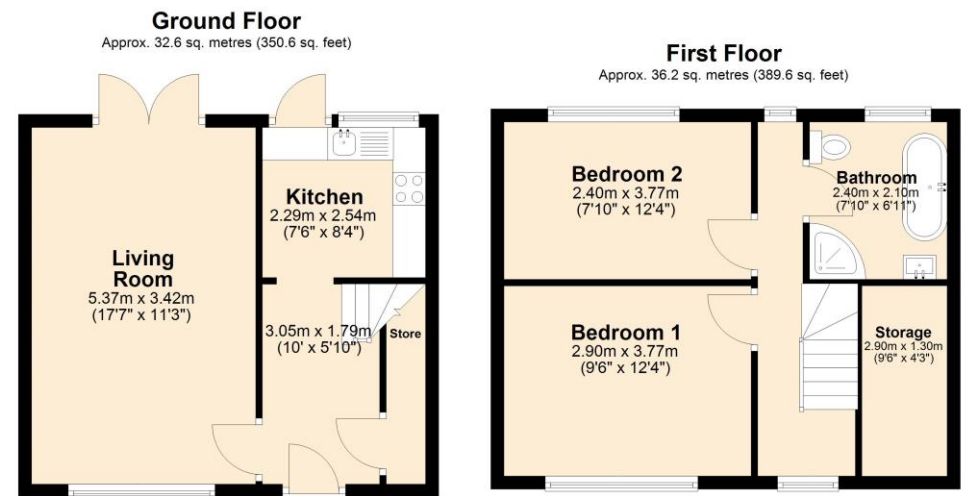

Total area: approx. 68.8 sq. metres (740.2 sq. feet)

- Freehold
- EPC TBC
- Council Tax Band B





The Property Man

102A School Road

Sale

Cheshire

M33 7XB

T: 01615198855

E: sales@thepropertyman.co.uk

www.thepropertyman.co.uk

The Property Man

Registered Office Address: 7 St. Petersgate, Stockport, England, SK1 1EB Company Reg No: 09023087

Disclaimer

Every attempt has been made to ensure accuracy, however these property particulars are approximate and for illustrative purposes only. They have been prepared in good faith and they are not intended to constitute part of an offer of contract. We have not carried out a structural survey and the services, appliances and specific fittings have not been tested. All photographs, measurements, floor plans and distances referred to are given as a guide only and should not be relied upon for the purchase of any fixture or fittings. Lease details, service charges and ground rent (where applicable) are given as a guide only and should be checked prior to agreeing a sale.