



Alma Road, Sale, Cheshire, M33

Guide Price: £75,000

Leasehold

Alma Road, Sale, Cheshire, M33

Situated in the popular over 55's retirement development 'Woodhey Court' is this second floor ONE BEDROOM apartment. In need of some modernisation throughout this home is perfect for someone wanting to put their own stamp on their new home.

The apartment offers a bright and airy living room lit via a large window which allows natural light to flood the apartment. The kitchen is open to the living room and is fitted with a range of base and eye level units. There is a good size double bedroom, and the main bathroom offers a three-piece bathroom suite.

Woodhey Court is located on Alma Road which is perfectly positioned close to Sale Town Centre, motorway networks and within easy reach of local shops and amenities. The development itself offers a communal living room where residents partake in coffee mornings, bingo and other social events. There is off road parking for residents and visitors as well as well-maintained communal grounds for homeowners to enjoy,

99 years from 25 December 1987
Service Charge: £201.65 per month

- Leasehold
- Council Tax Band B
- EPC Grade TBC

Ground Floor

Approx. 43.4 sq. metres (466.9 sq. feet)

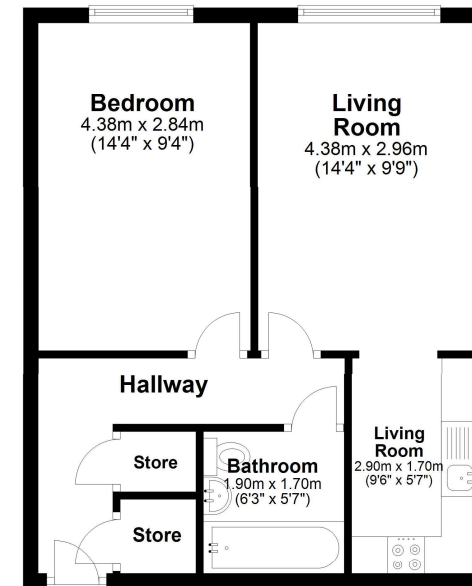

Total area: approx. 43.4 sq. metres (466.9 sq. feet)





The Property Man

102A School Road
Sale
Cheshire
M33 7XB

T: 01615198855

E: sales@thepropertyman.co.uk

www.thepropertyman.co.uk

The Property Man

Registered Office Address: 7 St. Petersgate, Stockport, England, SK1 1EB Company Reg No: 09023087

Disclaimer

Every attempt has been made to ensure accuracy, however these property particulars are approximate and for illustrative purposes only. They have been prepared in good faith and they are not intended to constitute part of an offer of contract. We have not carried out a structural survey and the services, appliances and specific fittings have not been tested. All photographs, measurements, floor plans and distances referred to are given as a guide only and should not be relied upon for the purchase of any fixture or fittings. Lease details, service charges and ground rent (where applicable) are given as a guide only and should be checked prior to agreeing a sale.