



Farmers Close, Sale, Cheshire, M33

**Offers in the region of:
£575,000**

Farmers Close, Sale, Cheshire, M33

Nestled in a quiet cul-de-sac, this well presented four-bedroom detached home is a true gem in Sale Moor. With its prime location near Sale Water Park, convenient access to motorway networks, Metrolink and excellent schooling options, this property makes for an ideal family home.

The property offers spacious accommodation throughout and the ground floor is home to a bright and airy living room which is open to the fantastic size dining room. The feature floor to ceiling windows and bi-folding doors lead to the rear garden. There is a modern fitted kitchen diner with a range of base and eye level units and space for dining table and chairs. There is also the added benefit of a utility room and downstairs WC.

The first floor reveals FOUR bedrooms, the main bedroom is fitted with wardrobes and offers a newly fitted en-suite bathroom with walk in shower.

Externally there is off road parking for several cars and access to the properties detached garage which offers fantastic storage with power and light. The rear garden is low maintenance with fence boundaries.

- Leasehold
- EPC Grade TBC
- Council Tax Band D

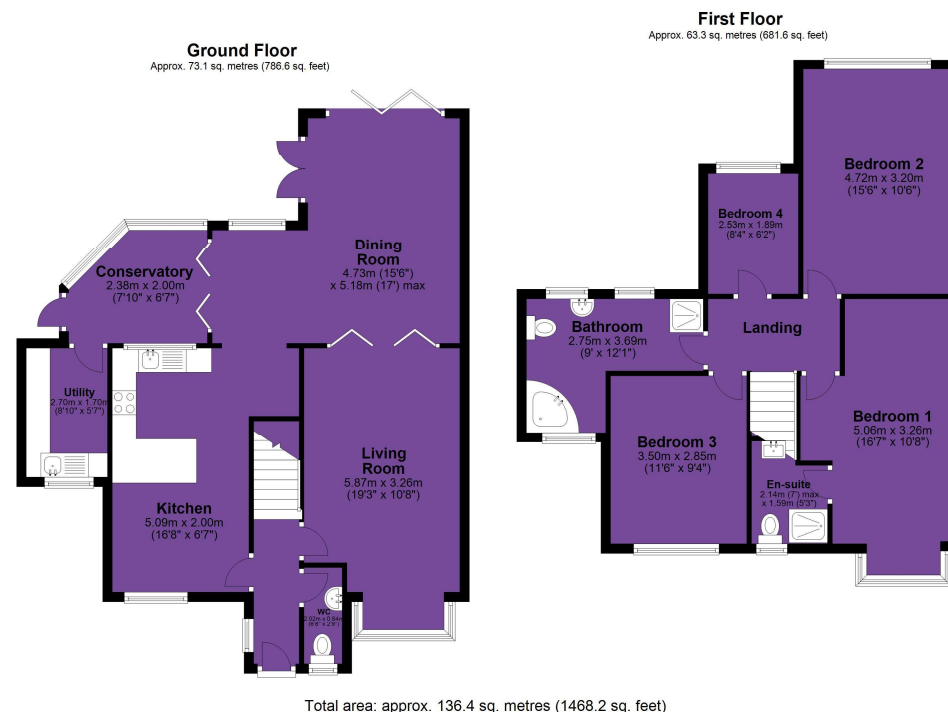





The Property Man

102A School Road

Sale

Cheshire

M33 7XB

T: 01615198855

E: sales@thepropertyman.co.uk

www.thepropertyman.co.uk

The Property Man

Registered Office Address: 7 St. Petersgate, Stockport, England, SK1 1EB Company Reg No: 09023087

Disclaimer

Every attempt has been made to ensure accuracy, however these property particulars are approximate and for illustrative purposes only. They have been prepared in good faith and they are not intended to constitute part of an offer of contract. We have not carried out a structural survey and the services, appliances and specific fittings have not been tested. All photographs, measurements, floor plans and distances referred to are given as a guide only and should not be relied upon for the purchase of any fixture or fittings. Lease details, service charges and ground rent (where applicable) are given as a guide only and should be checked prior to agreeing a sale.