





# Butts Road Southampton SO19 1DD

for sale offers over  
**£250,000**



## Property Description

Modern 2-Bedroom End-of-Terrace Home with Driveway and Stylish Interiors. Situated in a sought-after residential area, this beautifully presented 2-bedroom end-of-terrace home offers a perfect blend of modern living and practical design. With its own front driveway, the property provides convenient off-street parking.

Inside, you'll find a spacious modern kitchen/diner, ideal for entertaining or family meals, along with a contemporary bathroom finished to a high standard. The large master bedroom offers plenty of space for wardrobes and relaxation, while the second bedroom is perfect as a guest room, nursery, or home office.

To the rear, enjoy an easy-to-maintain garden with side access, ideal for outdoor dining, children's play, or simply unwinding. This charming home is perfect for first-time buyers, small families, or anyone looking to downsize without compromising on style or convenience.

## Lounge

Double glazed windows to front, radiator to front, laminate flooring

## Kitchen/Diner

Wall and base units, lino flooring, gas cooker, radiator to side, roll top work tops - stainless steel sink and drainer, under stairs storage

## Landing

Loft access - boarded, double glazed window

## Bedroom One

1 wardrobe in room, double glazed window to front, laid to carpet

## Bedroom Two

Double glazed window to rear, radiator to rear, laid to carpet

## Bathroom

W/C handwash basin, vanity unit, double glazed window to rear, partially tiled floor

## Rear Garden

Side access

## KEY FEATURES

Two Bedrooms

End-of-Terrace Position

Private Front Driveway

Modern Kitchen/Diner

Contemporary Bathroom

Low-Maintenance Rear Garden

Well-Presented Throughout











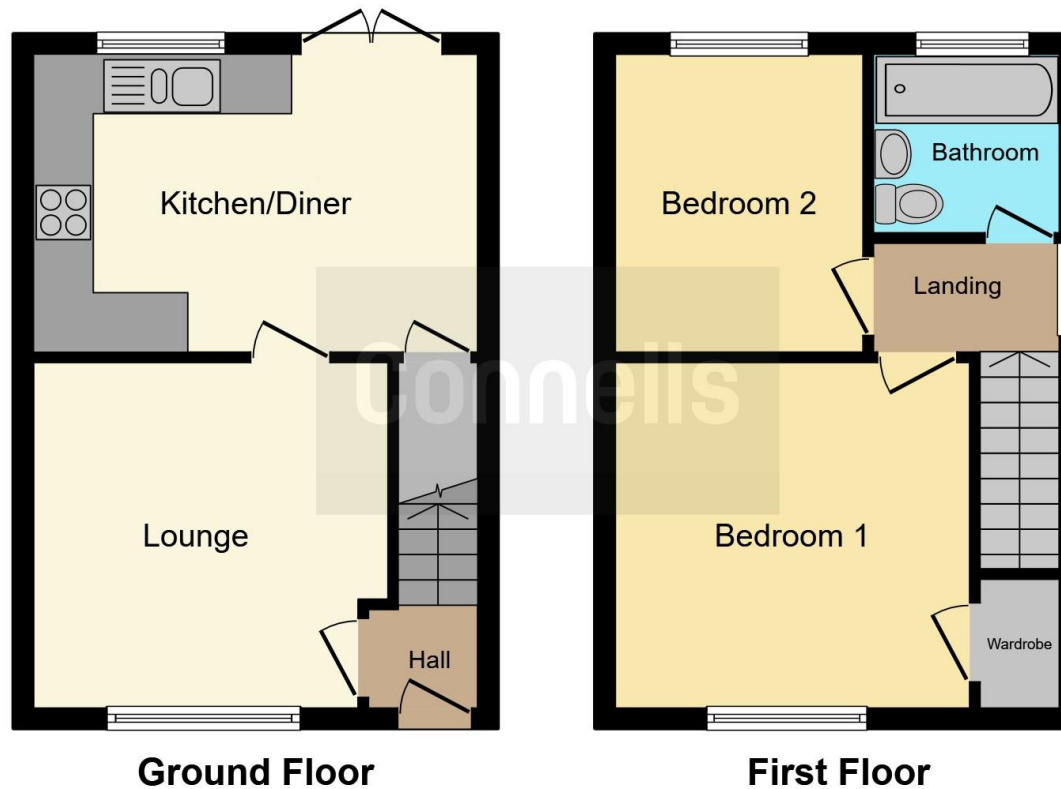

This floor plan is for illustrative purposes only. It is not drawn to scale. Any measurements, floor areas (including any total floor area), openings and orientation are approximate. No details are guaranteed, they cannot be relied upon for any purpose and they do not form part of any agreement. No liability is taken for any error, omission or misstatement. A party must rely upon its own inspection(s). Powered by [www.focalagent.com](http://www.focalagent.com)

To view this property please contact Connells on

**T 02380 422080**  
**E [Bitterne@connells.co.uk](mailto:Bitterne@connells.co.uk)**

2 West End Road Bitterne  
 SOUTHAMPTON SO18 6TG

EPC Rating: C Council Tax  
 Band: B

Tenure: Freehold

**view this property online [connells.co.uk/Property/BTN107311](http://connells.co.uk/Property/BTN107311)**



1. MONEY LAUNDERING REGULATIONS Intending purchasers will be asked to produce identification documentation at a later stage and we would ask for your co-operation in order that there will be no delay in agreeing the sale. 2. These particulars do not constitute part or all of an offer or contract. 3. The measurements indicated are supplied for guidance only and as such must be considered incorrect. Potential buyers are advised to recheck measurements before committing to any expense. 4. We have not tested any apparatus, equipment, fixtures, fittings or services and it is in the buyers interest to check the working condition of any appliances.

Connells Residential is registered in England and Wales under company number 1489613, Registered Office is Cumbria House, 16-20 Hockliffe Street, Leighton Buzzard, Bedfordshire, LU7 1GN. VAT Registration Number is 500 2481 05.

**See all our properties at [www.connells.co.uk](http://www.connells.co.uk) | [www.rightmove.co.uk](http://www.rightmove.co.uk) | [www.zoopla.co.uk](http://www.zoopla.co.uk)**

Property Ref: BTN107311 - 0005