



**Connells**

Edmondson Close  
Dunchurch Rugby

# Edmondson Close Dunchurch Rugby CV22 6RY

for sale  
£375,000



## Property Description

Nestled in the highly sought-after village of Dunchurch, this exceptional three-bedroom bungalow offers a rare opportunity to enjoy refined, single-level living in a beautifully crafted home. Designed with meticulous attention to detail, this property combines timeless elegance with modern convenience.

Upon entry, a welcoming hallway with luxurious herringbone-style flooring sets the tone for the rest of the home. At its heart lies a stunning open-plan kitchen, living, and dining area—flooded with natural light from striking corner bi-fold doors that seamlessly connect the interior to the enclosed rear garden, ideal for entertaining and al fresco dining.

The bespoke shaker-style kitchen is a true centrepiece, featuring quartz worktops and a full suite of integrated appliances including an oven, hob, extractor, microwave, fridge-freezer, dishwasher, and washer/dryer.

Each of the three bedrooms offers flexibility for family living or home working. The principal bedroom benefits from a stylish en-suite, while the family bathroom is equally impressive—complete with contemporary fittings, electric mirrors, and a rainfall showerhead.

Sustainability and comfort are at the forefront of this home's design, with air source heating, underfloor heating throughout, and triple-glazed windows ensuring year-round efficiency and reduced energy costs.

Externally, two off-street parking spaces, an electric vehicle charging point, and a private rear garden perfect for summer gatherings.

## Entrance Hallway

## Lounge/Kitchen Diner

20' 1" x 15' 9" ( 6.12m x 4.80m )

## Bedroom 1

12' 5" x 9' 10" ( 3.78m x 3.00m )

## Bedroom 2

10' x 8' 11" ( 3.05m x 2.72m )

## Bedroom 3 / Study

11' 11" x 8' ( 3.63m x 2.44m )

## Bathroom

## En-Suite







# Edmondson Close

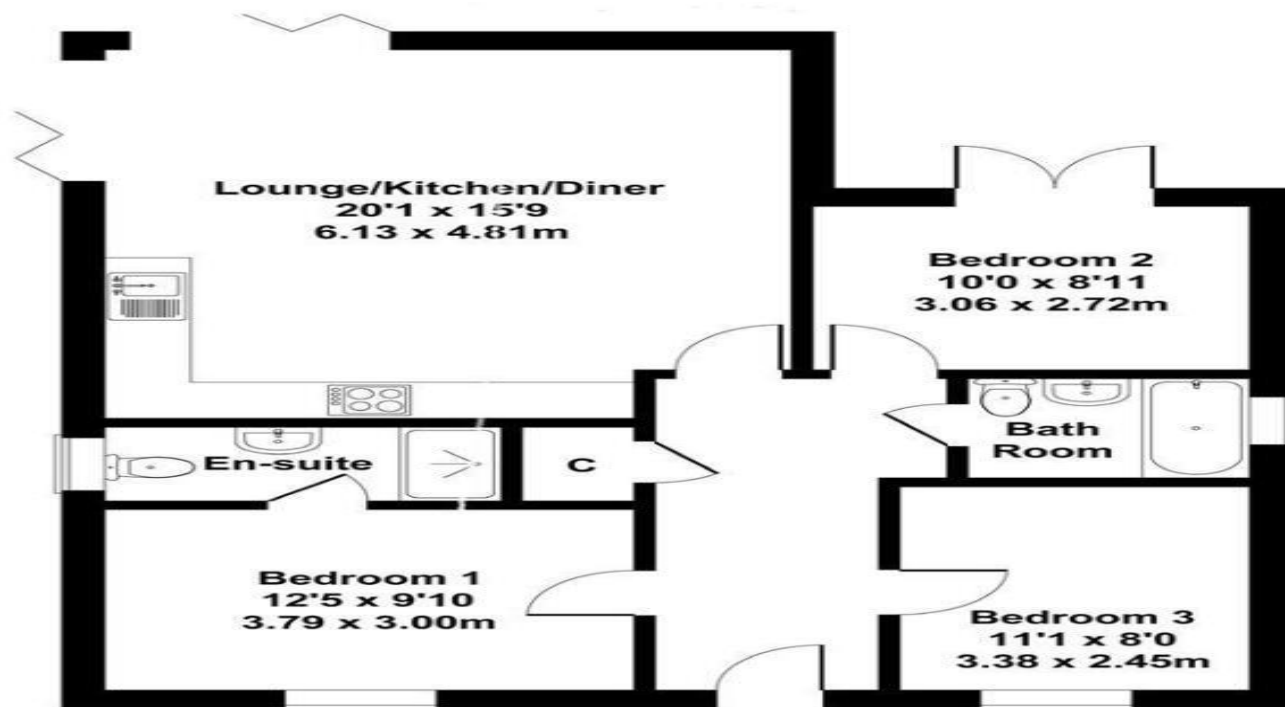

## GROUND FLOOR

### SKETCH PLAN FOR ILLUSTRATIVE PURPOSES ONLY

All measurements walls, doors, windows, fittings and appliances, their sizes and locations, are approximate only. They cannot be regarded as being a representation by the seller, nor their agent.

Produced by Potterplans Ltd. 2025

To view this property please contact Connells on

**T 01788 579880**  
**E [Rugby@connells.co.uk](mailto:Rugby@connells.co.uk)**

25 Regent Street  
RUGBY CV21 2PE

EPC Rating:  
Exempt

Tenure: Freehold

**view this property online [connells.co.uk/Property/RBY107664](https://connells.co.uk/Property/RBY107664)**



1. MONEY LAUNDERING REGULATIONS Intending purchasers will be asked to produce identification documentation at a later stage and we would ask for your co-operation in order that there will be no delay in agreeing the sale. 2. These particulars do not constitute part or all of an offer or contract. 3. The measurements indicated are supplied for guidance only and as such must be considered incorrect. Potential buyers are advised to recheck measurements before committing to any expense. 4. We have not tested any apparatus, equipment, fixtures, fittings or services and it is in the buyers interest to check the working condition of any appliances.

Connells Residential is registered in England and Wales under company number 1489613, Registered Office is Cumbria House, 16-20 Hockliffe Street, Leighton Buzzard, Bedfordshire, LU7 1GN. VAT Registration Number is 500 2481 05.

**See all our properties at [www.connells.co.uk](https://www.connells.co.uk) | [www.rightmove.co.uk](https://www.rightmove.co.uk) | [www.zoopla.co.uk](https://www.zoopla.co.uk)**

Property Ref: RBY107664 - 0003