



Connells

Wynne Crescent
RUGBY



Property Description

A modern two bedroom semi-detached property in a highly sought after location close to local shops, schools and amenities and within walking distance to Rugby train station, Rugby College and Elliott's Field shopping park. Briefly comprising of entrance hall, guest cloakroom, modern kitchen, lounge, two good size bedrooms and family bathroom. The property also benefits from an enclosed rear garden with rear access and parking to the front.

Entrance Hall

Cloakroom

w/c Window to front.

Lounge

13' 3" x 13' 5" Max (4.04m x 4.09m Max)

French doors to rear, karndean flooring, store cupboard.

Kitchen

9' 10" x 6' (3.00m x 1.83m)

Window to front, sink & drainer, oven, four ring gas hob, space for washing machine & dish washer.

Bedroom One

13' 5" x 8' 5" Max (4.09m x 2.57m Max)

Fitted wardrobes, windows to front.

Bedroom Two

13' 6" x 8' 2" (4.11m x 2.49m)

Windows to front

Bathroom

Shower over bath, part tiled

Rear Garden

Lawn & patio, side access, shed







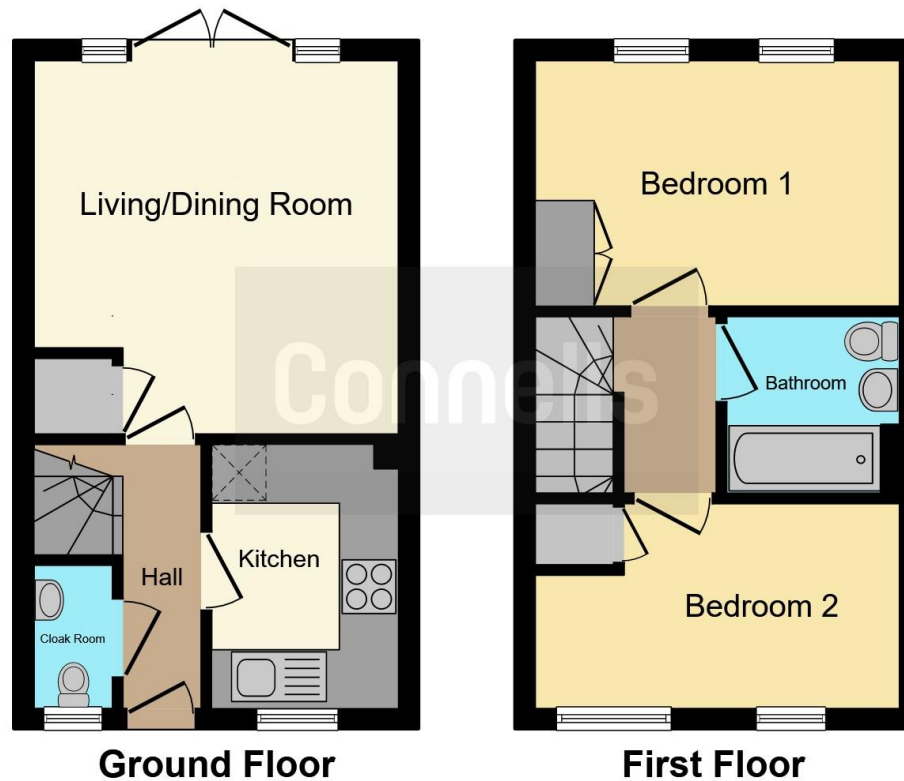

This floor plan is for illustrative purposes only. It is not drawn to scale. Any measurements, floor areas (including any total floor area), openings and orientation are approximate. No details are guaranteed, they cannot be relied upon for any purpose and they do not form part of any agreement. No liability is taken for any error, omission or misstatement. A party must rely upon its own inspection(s). Powered by www.focalagent.com

To view this property please contact Connells on

T 01788 579880
E Rugby@connells.co.uk

25 Regent Street
 RUGBY CV21 2PE

EPC Rating: B

view this property online connells.co.uk/Property/RBY106353

Tenure: Freehold



1. MONEY LAUNDERING REGULATIONS Intending purchasers will be asked to produce identification documentation at a later stage and we would ask for your co-operation in order that there will be no delay in agreeing the sale. 2. These particulars do not constitute part or all of an offer or contract. 3. The measurements indicated are supplied for guidance only and as such must be considered incorrect. Potential buyers are advised to recheck measurements before committing to any expense. 4. We have not tested any apparatus, equipment, fixtures, fittings or services and it is in the buyers interest to check the working condition of any appliances.

Connells Residential is registered in England and Wales under company number 1489613, Registered Office is Cumbria House, 16-20 Hockliffe Street, Leighton Buzzard, Bedfordshire, LU7 1GN. VAT Registration Number is 500 2481 05.

See all our properties at www.connells.co.uk | www.rightmove.co.uk | www.zoopla.co.uk

Property Ref: RBY106353 - 0003