



Your Logo

**Wardell Apartments,, Bartlet Close, London**  
Offers In Region Of £525,000

🛏 2 🚿 2



Ashley King Canary Wharf are delighted to present this rare to the market, two bedroom two bathroom apartment opposite Bartlet park.





**Floor Area**  
800 sq. ft.

**Tenure**  
Leasehold

**Service Charge**  
£2400 per annum

**Ground Rent**  
£0 per annum



## Wardell Apartments, E14 6US

Approx Gross Internal Area = 72.44 sq m / 779 sq ft

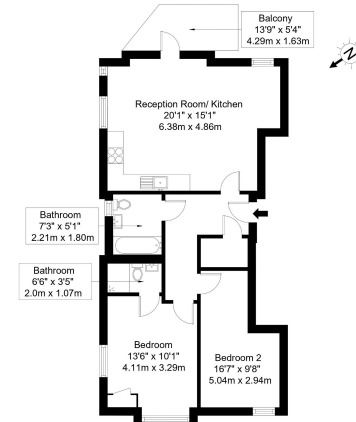

Ref : Copyright B L E U P L A N

The Floor plan is not to scale and measurements and areas shown are approximate and therefore should be used for illustrative purposes only. The plan has been prepared in accordance with the RICS Code of Measuring Practice and while we have confidence in the information produced it must not be relied on. If there is any aspect of particular importance, you should carry out or commission your own inspection of the property.  
Copyright © BLSUPPLAN.

## Energy Efficiency Rating

	Current	Potential
<i>Very energy efficient - lower running costs</i>		
(92 plus) <b>A</b>		
(81-91) <b>B</b>	83	83
(69-80) <b>C</b>		
(55-68) <b>D</b>		
(39-54) <b>E</b>		
(21-38) <b>F</b>		
(1-20) <b>G</b>		
<i>Not energy efficient - higher running costs</i>		
<b>England &amp; Wales</b>	EU Directive 2002/91/EC	