

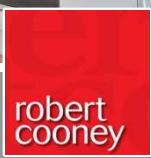

30 Bilberries Close Monkton Heathfield, Taunton TA2 8SW

£235,000



30 Bilberries Close, Monkton Heathfield, Taunton, TA2 8SW

Approximate Area = 620 sq ft / 57.5 sq m

For identification only - Not to scale

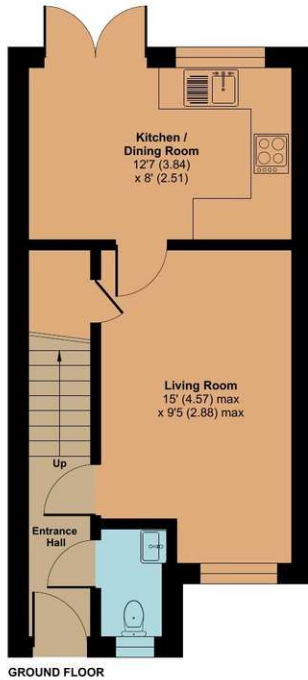

GROUND FLOOR

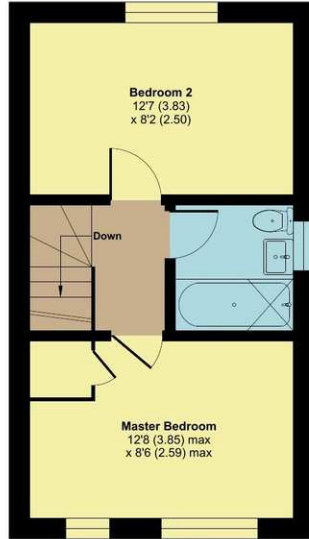

FIRST FLOOR



Features

- Entrance Hall
- Living Room
- Fitted Kitchen / Dining Room with French doors to garden
- Cloakroom
- Master Bedroom with fitted storage
- Further double Bedroom
- Family Bathroom
- Enclosed South-East facing garden to rear with useful shed
- Driveway parking
- Gas central heating
- Double glazing
- NHBS Warranty - 5 years remaining
- Management charge £200 pa - reviewed January 2027
- Council tax band B
- What3words: [///pegs.hinders.gripes](#)

Situated in this sought after location within 3 miles of the centre of town is this immaculately presented 2 double bedroomed end-terrace house with enclosed South East facing garden to rear and driveway parking. No onward chain.



Viewing strictly through the selling agents:

Robert Cooney

Corporation Street, Taunton, Somerset TA1 4AW

Telephone: 01823 230230
taunton@robertcooney.co.uk
robertcooney.co.uk

**robert
cooney**

For clarification, we wish to inform prospective purchasers that: these particulars are set out as a general outline only for the guidance of intended purchasers, and do not constitute, nor constitute part of, an offer or contract; all descriptions, dimensions, references to condition and necessary permission for use and occupation, and other details, are given without responsibility and any intending purchasers should not rely on them as statements or representation of fact, but must satisfy themselves by inspection or otherwise as to the correctness of each of them; no person in the employment of Robert Cooney has any authority to make or give any representation or warranty whatever in relation to this property; we have not carried out a detailed survey nor tested the services, appliances and specific fittings.