



11 Gyffarde Street Taunton TA1 1JX

£299,000

robert
cooney

11 Gyffarde Street, Taunton, TA1 1JX

Approximate Area = 1350 sq ft / 125.4 sq m

Outbuilding = 5 sq ft / 0.4 sq m

Total = 1355 sq ft / 125.8 sq m

For identification only - Not to scale

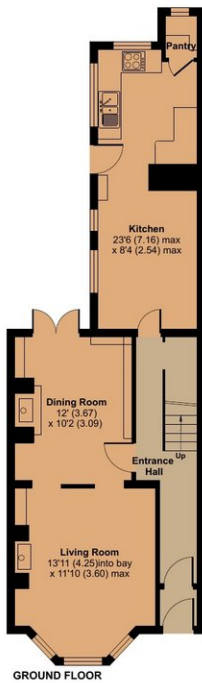

GROUND FLOOR



FIRST FLOOR

Tool Shed
2'11" (0.88)
x 1'10" (0.57)

OUTBUILDING



SECOND FLOOR

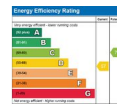

Features

- Entrance Porch
- Entrance Hall
- Living Room with woodburner
- Dining Room with French doors to garden
- Fitted Kitchen with door to garden
- Pantry
- Master Bedroom with fitted wardrobes
- 2 further Bedrooms on 1st floor
- Family Bathroom
- Further double bedroom on 2nd floor
- Enclosed courtyard garden to rear
- Gas central heating
- Double glazing
- Council tax band B

Convenient situated within a few minutes' level walk to the centre of town is this 4 bedroomed mid-terraced Victorian house arranged over 3 floors with 2 reception rooms and enclosed courtyard garden to rear.



Viewing strictly through the selling agents:

Robert Cooney

Corporation Street, Taunton, Somerset TA1 4AW

Telephone: 01823 230230

taunton@robertcooney.co.uk

robertcooney.co.uk

**robert
cooney**

For clarification, we wish to inform prospective purchasers that: these particulars are set out as a general outline only for the guidance of intended purchasers, and do not constitute, nor constitute part of, an offer or contract; all descriptions, dimensions, references to condition and necessary permission for use and occupation, and other details, are given without responsibility and any intending purchasers should not rely on them as statements or representation of fact, but must satisfy themselves by inspection or otherwise as to the correctness of each of them; no person in the employment of Robert Cooney has any authority to make or give any representation or warranty whatever in relation to this property; we have not carried out a detailed survey nor tested the services, appliances and specific fittings.