

## 27 Cambridge Mill

5 Cambridge Street, Manchester, M1 5GF

**\*\*AVAILABLE 5th SEPTEMBER - VIDEO TOUR ATTACHED - PHYSICAL VIEWINGS ONLY - Spacious 2 Bedroom, 2 Bathroom apartment in the Grade 2 listed development in the heart of the city. Housing many original features. Ideal location for all transport links and minutes from Manchester's Universities**

**\*\*THE PROPERTY WILL ONLY BE LET FOLLOWING A PHYSICAL VIEWING BEING CARRIED OUT BY THE APPLICANT OR THEIR REPRESENTATIVE\*\***

**\*\*\*NO CORPORATE LETTING or SHORT-TERM LETTINGS ALLOWED\*\*\***

**\*\*12 Month Minimum Contract required by Landlord\*\***

**£1,400 PCM**

## 27 Cambridge Mill

5 Cambridge Street, Manchester, M1 5GF



- 2 GOOD SIZE DOUBLE BEDROOMS
- 2 BATHROOMS
- FULL FURNISHED
- FITTED KITCHEN WITH INTEGRATED APPLIANCES
- JULIETTE BALCONY
- SUITABLE FOR STUDENTS & PROFESSIONALS
- CLOSE TO PICCADILLY & OXFORD RD STATIONS
- CLOSE TO UNIVERSITIES
- OPTIONAL SECURE PARKING 5 MINUTES AWAY - £100.00PM



[Directions](#)







Floor Plan

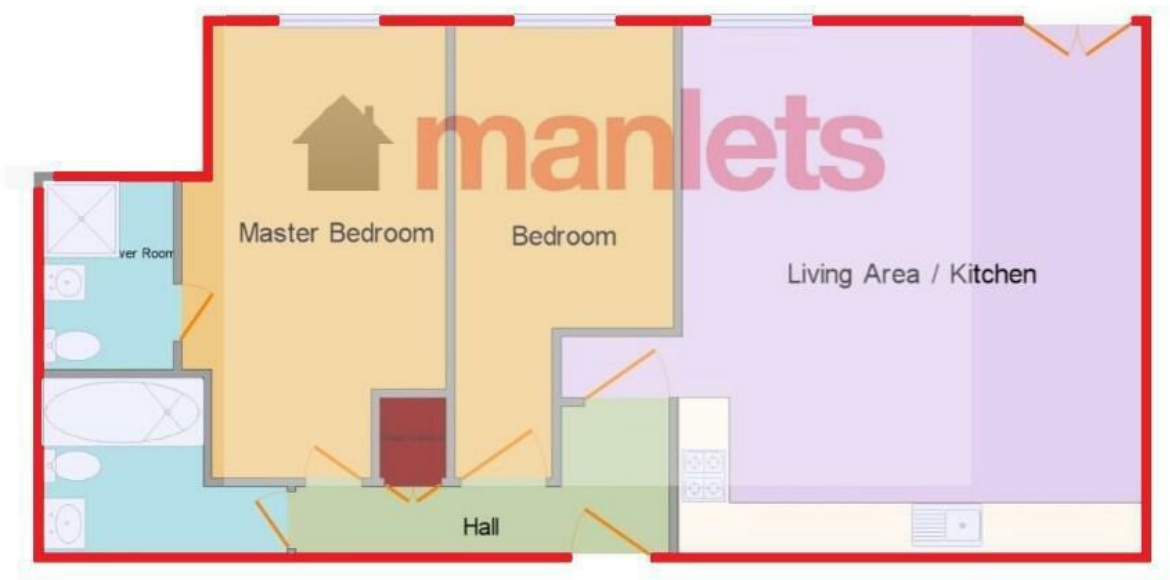

These particulars, whilst believed to be accurate are set out as a general outline only for guidance and do not constitute any part of an offer or contract. Intending purchasers should not rely on them as statements of representation of fact, but must satisfy themselves by inspection or otherwise as to their accuracy. No person in this firms employment has the authority to make or give any representation or warranty in respect of the property.

Bridgewater House, 58-60 Whitworth Street, Manchester, M1 6LT  
Tel: 01612388978 Email: info@manlets.com <https://manlets.com/>

Energy Efficiency Rating		
	Current	Potential
Very energy efficient - lower running costs		
(92 plus) A		80
(81-91) B		
(69-80) C		
(55-68) D	45	
(39-54) E		
(21-38) F		
(1-20) G		
Not energy efficient - higher running costs		
England & Wales		EU Directive 2002/91/EC