

# Frank Harris & Co.



## Jessel House, WC1H

£650 Per week

A well presented 2nd floor property set within this imposing and attractive mansion block in the heart of Bloomsbury. The apartment is bright, has a separate kitchen and living area and has also recently been refurbished.

Jessel House is centrally located and just moments to Kings Cross, Russell Square Underground and the amenities of the Brunswick Centre.

- Two-Bedroom • Bright • Refurbished •
- Secure Building • Central Location • Lift •

# Frank Harris & Co.

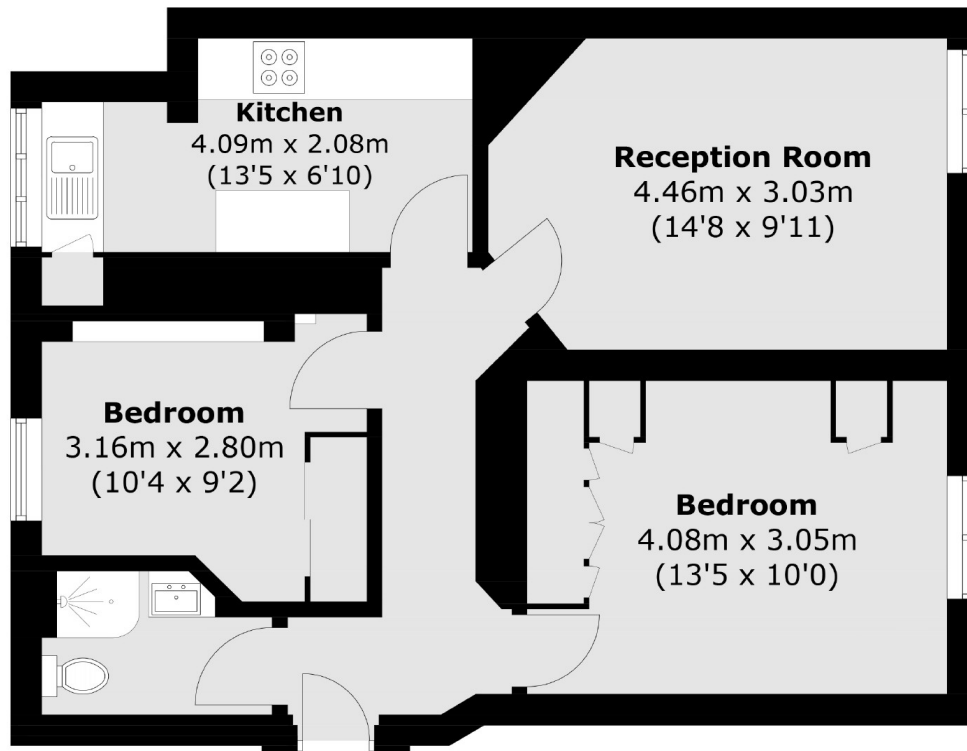

Total area (approx.): 56.2 sq. m (604.9 sq. ft)

Frank Harris & Co. Bloomsbury and Kings Cross  
81 Marchmont Street, London,  
WC1N 1AL  
020 7387 0077  
[bloomsburylettings@frankharris.co.uk](mailto:bloomsburylettings@frankharris.co.uk)

Energy Rating: D. We aim to make our particulars both accurate and reliable. However they are not guaranteed; nor do they form part of an offer or contract. If you require clarification on any points then please contact us, especially if you're traveling some distance to view. Please note that appliances and heating systems have not been tested and therefore no warranties can be given as to their good working order.

