

# Frank Harris — & Co. —



## Bloomsbury Square, WC1A

£600 pcm

Located right on Bloomsbury Square is this top-floor one bedroom apartment. Fitted with wooden flooring throughout, a modern eat-in kitchen and offered furnished. Available end of July.

The property is located 0.2 miles from Holborn Underground Station and 0.3 Miles from Covent Garden.

- Top-floor (with lift) • Wooden flooring • Modern fixtures & fittings •
- Secure building • Located on a garden square • Furnished •

# Frank Harris & Co.

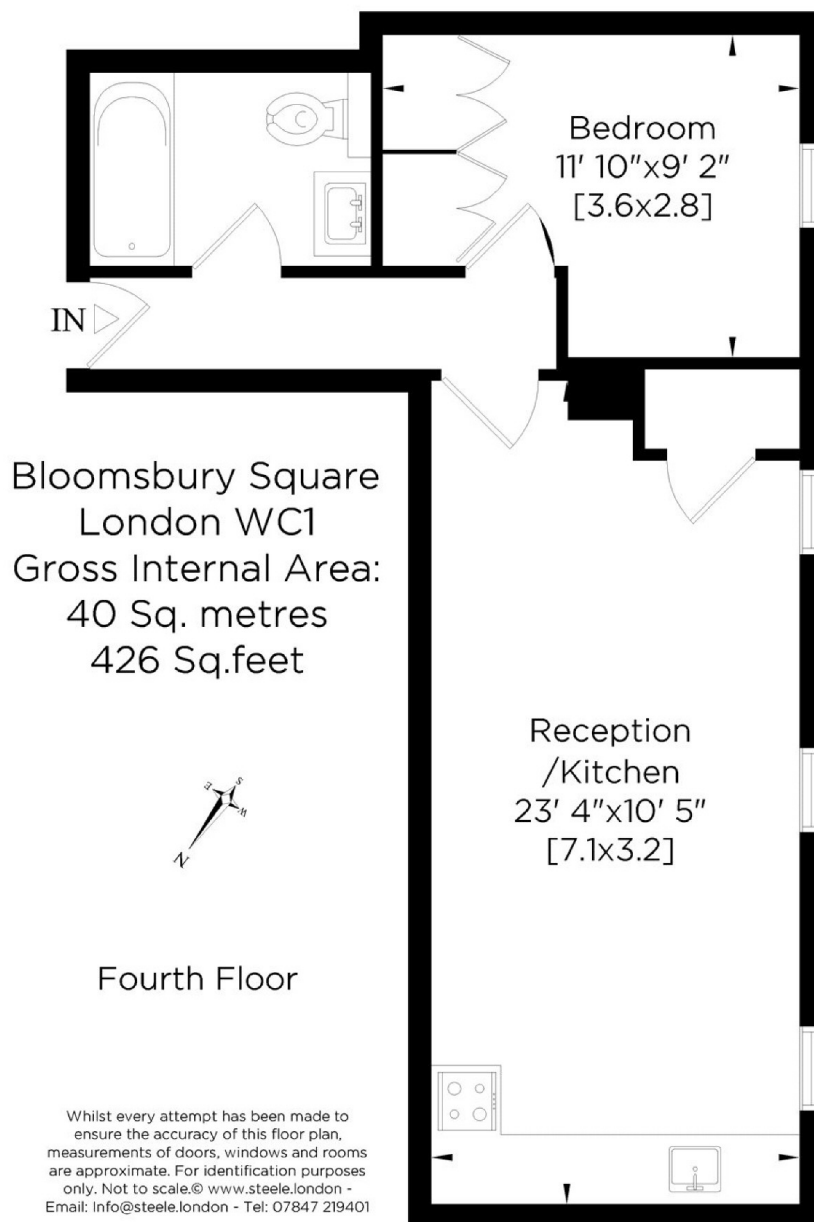

Frank Harris & Co. Bloomsbury and Kings Cross  
81 Marchmont Street,  
London, WC1N 1AL  
020 7387 0077  
bloomsburylettings@frankharris.co.uk

Energy Rating: C. We aim to make our particulars both accurate and reliable. However they are not guaranteed; nor do they form part of an offer or contract. If you require clarification on any points then please contact us, especially if you're traveling some distance to view. Please note that appliances and heating systems have not been tested and therefore no warranties can be given as to their good working order.