

# Frank Harris

— & Co. —



## Bloomsbury, WC1N

£1,038 pcm

A rarely available, stunning and exceptionally spacious three bedroom mews house quietly located on a cobbled mews in the heart of Bloomsbury. Set over two floors the house has a large open-plan living/kitchen with high ceilings, wood floors, double doors, three double bedrooms, 1.5 Bathrooms and is neutrally decorated throughout.

Colonnade is a quiet mews conveniently located just behind Russell Square Underground station and is just a few yards away from the many shops and local amenities of the Brunswick Center including Waitrose Super market and local cinema.

- Mews House • Three Bedrooms/two bathrooms • High Ceilings •
- Wood Floors Throughout • Underfloor Heating • Stylish Modern Kitchen •

# Frank Harris & Co.

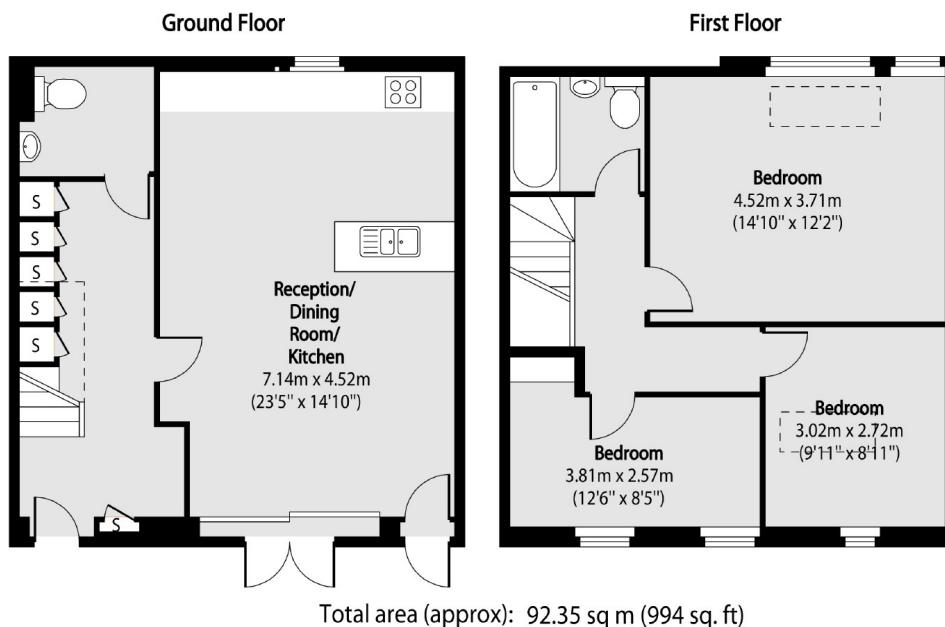

Frank Harris & Co. Bloomsbury and Kings Cross  
81 Marchmont Street,  
London, WC1N 1AL  
020 7387 0077  
bloomsburylettings@frankharris.co.uk

Energy Rating: B. We aim to make our particulars both accurate and reliable. However they are not guaranteed; nor do they form part of an offer or contract. If you require clarification on any points then please contact us, especially if you're traveling some distance to view. Please note that appliances and heating systems have not been tested and therefore no warranties can be given as to their good working order.

