

Frank Harris & Co.



Russell Court, WC1H

£310,000

One of the larger, bright west facing studios set within a newly renovated 1930's mansion block. The property includes a separate kitchen, family bathroom and open plan living/bedroom area with a built in bed and generous storage as well as a bay window. Heating and hot water is included in the annual service charge.

Located just moments from Russell Square tube station and the Brunswick Centre with a Waitrose supermarket as well as many shops and restaurants. The West End and the Eurostar terminal at St Pancras are less than half a mile

Frank Harris & Co.

Third Floor

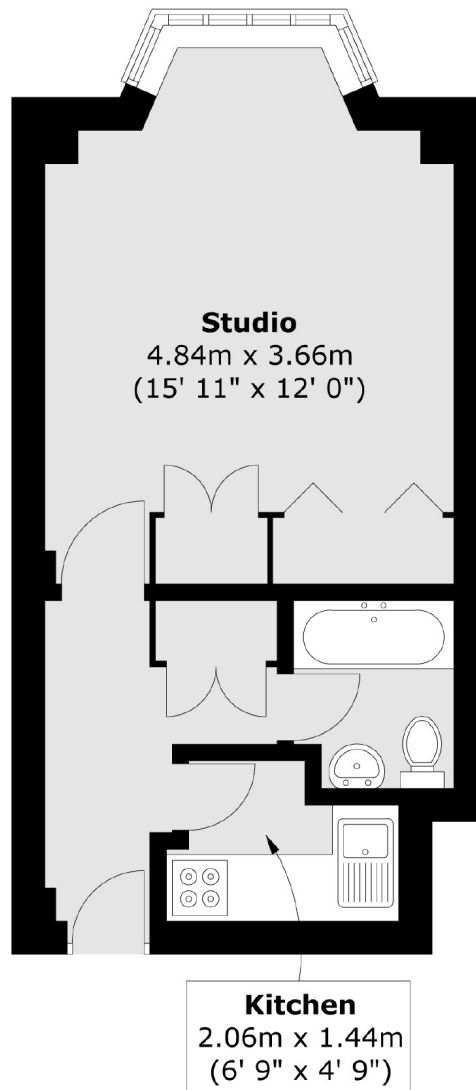

Total area (approx.) : 27.2 sq. m (293 sq. ft)

Frank Harris & Co. Bloomsbury and Kings Cross

81 Marchmont Street,

London, WC1N 1AL

020 7405 4444

bloomsburysales@frankharris.co.uk

Energy Rating: C. We aim to make our particulars both accurate and reliable. However they are not guaranteed; nor do they form part of an offer or contract. If you require clarification on any points then please contact us, especially if you're traveling some distance to view. Please note that appliances and heating systems have not been tested and therefore no warranties can be given as to their good working order.

