

Frank Harris & Co.



O'Donnell Court, WC1N

£1,000,000

Rare to the market is this two double bedroom apartment situated on the second floor of O'donnell Court. The property comprises of two bedrooms, one bathroom and a reception room off the kitchen. The Brunswick Centre is a Grade II listed building built in 1972, with this particular property benefitting from a East facing balcony as well as an extended lease.



The Brunswick Centre is situated in the centre of Bloomsbury, which offers an array of quality shops and restaurants including Waitrose and Curzon Cinema. Russell Square tube station (Picadilly Line) and King Cross St Pancras Station is a short walk away.

- Extended Lease • Private Balcony • Modernly Refurbished •
- Lift Access • 2nd Floor • East Facing •



Frank Harris & Co.

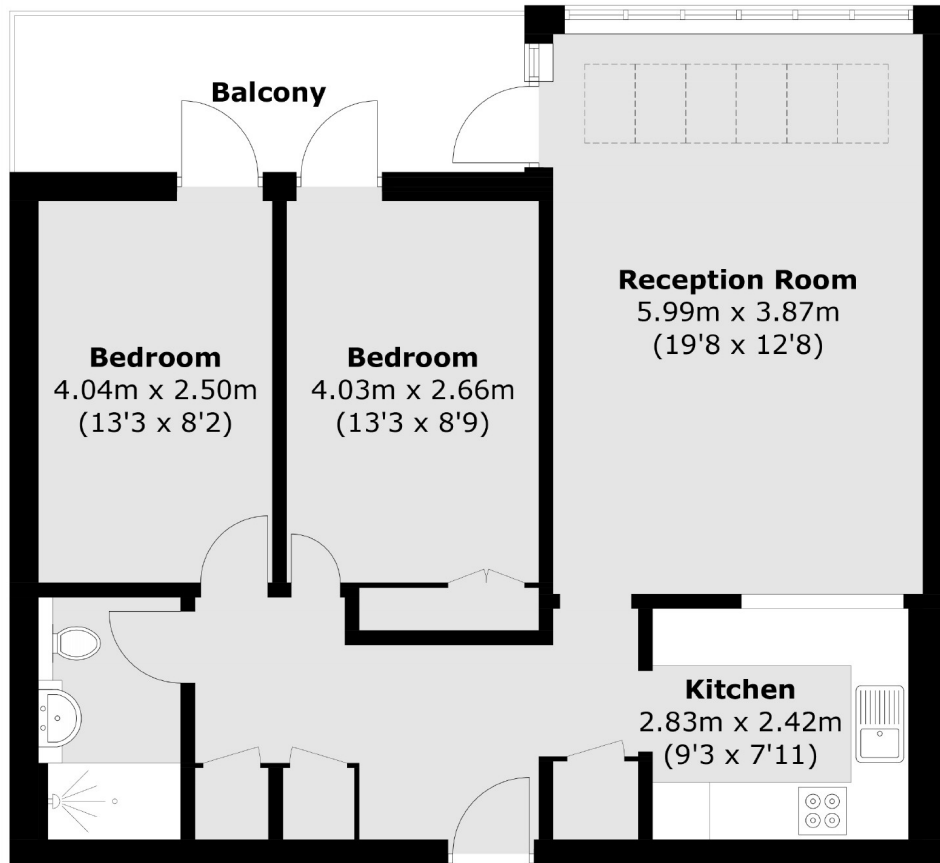

Total area (approx.): 69.3 sq. m (745.9 sq. ft)
Balcony : 8.7 sq. m (93.6 sq. ft)

Frank Harris & Co. Bloomsbury and Kings Cross

81 Marchmont Street,
London, WC1N 1AL

020 7405 4444

bloomsburysales@frankharris.co.uk

Energy Rating: D. We aim to make our particulars both accurate and reliable. However they are not guaranteed; nor do they form part of an offer or contract. If you require clarification on any points then please contact us, especially if you're traveling some distance to view. Please note that appliances and heating systems have not been tested and therefore no warranties can be given as to their good working order.

