

# Frank Harris & Co.



## Tamar House, WC1H

£575,000

A well appointed one double bedroom home located on the third floor with lift access. The property has a bright south facing living room, a separate kitchen and double bedroom with fitted wardrobes.

Tamar House is located in central Bloomsbury between both Tavistock and Russell Square. Nearby amenities include Russell Square underground, Euston, King's Cross St Pancras and numerous shopping facilities.

- One Double Bedroom • Lift Access • Neo-Georgian •
- Central Bloomsbury • Excellent Condition • No Onward Chain •

# Frank Harris & Co.

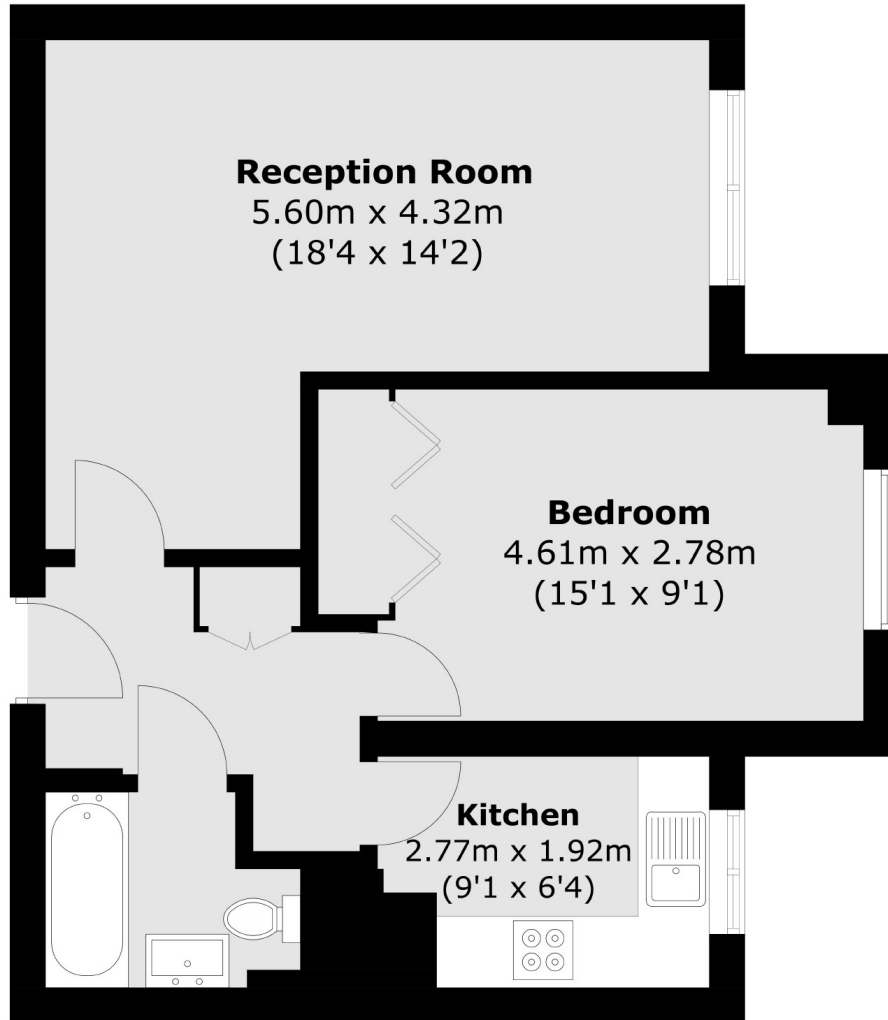

Total area (approx.): 48.6 sq. m (523.1 sq. ft)

Frank Harris & Co. Bloomsbury and Kings Cross  
81 Marchmont Street,  
London, WC1N 1AL  
020 7405 4444  
bloomsburysales@frankharris.co.uk

Energy Rating: C. We aim to make our particulars both accurate and reliable. However they are not guaranteed; nor do they form part of an offer or contract. If you require clarification on any points then please contact us, especially if you're traveling some distance to view. Please note that appliances and heating systems have not been tested and therefore no warranties can be given as to their good working order.

