

# Frank Harris & Co.



**Bloomsbury, WC1H**

**£600 Per week**

A Spacious and bright 1st floor apartment in this popular portered building. The property is lift accessible on the 1st floor, has plenty of built-in storage, and the heating and hot water is included.





Clare Court is located only 0.1 mile to the large Waitrose, selection of shops, restaurants, and cinema of the Brunswick Centre. It's 0.3 miles to both King's Cross Station and Russell Square Station.

- One double-bedroom • Porter • 1st floor with lift •
- Built-in storage • Heating and hot water inc • Furnished •





# Frank Harris & Co.

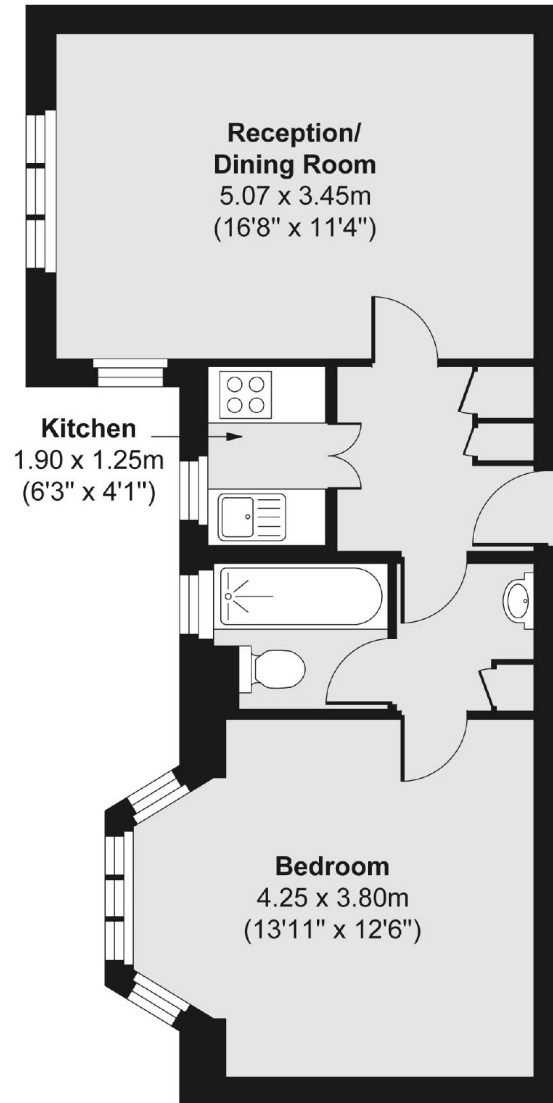

Total area (approx.) 45.23 sq. m (487 sq. ft)

Frank Harris & Co. Bloomsbury and Kings Cross  
81 Marchmont Street, London,  
WC1N 1AL  
020 7387 0077  
[bloomsburylettings@frankharris.co.uk](mailto:bloomsburylettings@frankharris.co.uk)

Energy Rating: C. We aim to make our particulars both accurate and reliable. However they are not guaranteed; nor do they form part of an offer or contract. If you require clarification on any points then please contact us, especially if you're traveling some distance to view. Please note that appliances and heating systems have not been tested and therefore no warranties can be given as to their good working order.

