

Frank Harris & Co.



Sandwich House, WC1H

£425,000

A one bedroom home within a period mansion block, there is a separate living room, re-fitted kitchen and bathroom, a double bedroom and access to an impressive residents only roof garden.

Sandwich House is a well regarded mansion block in the heart of Bloomsbury, there is an array of amenities including King's Cross to the north and Russell Square to the south.

- Period Mansion Block • Separate Living Room • Lift Access •
- Communal Roof Terrace • Share Of Freehold • Central Location •

Frank Harris & Co.

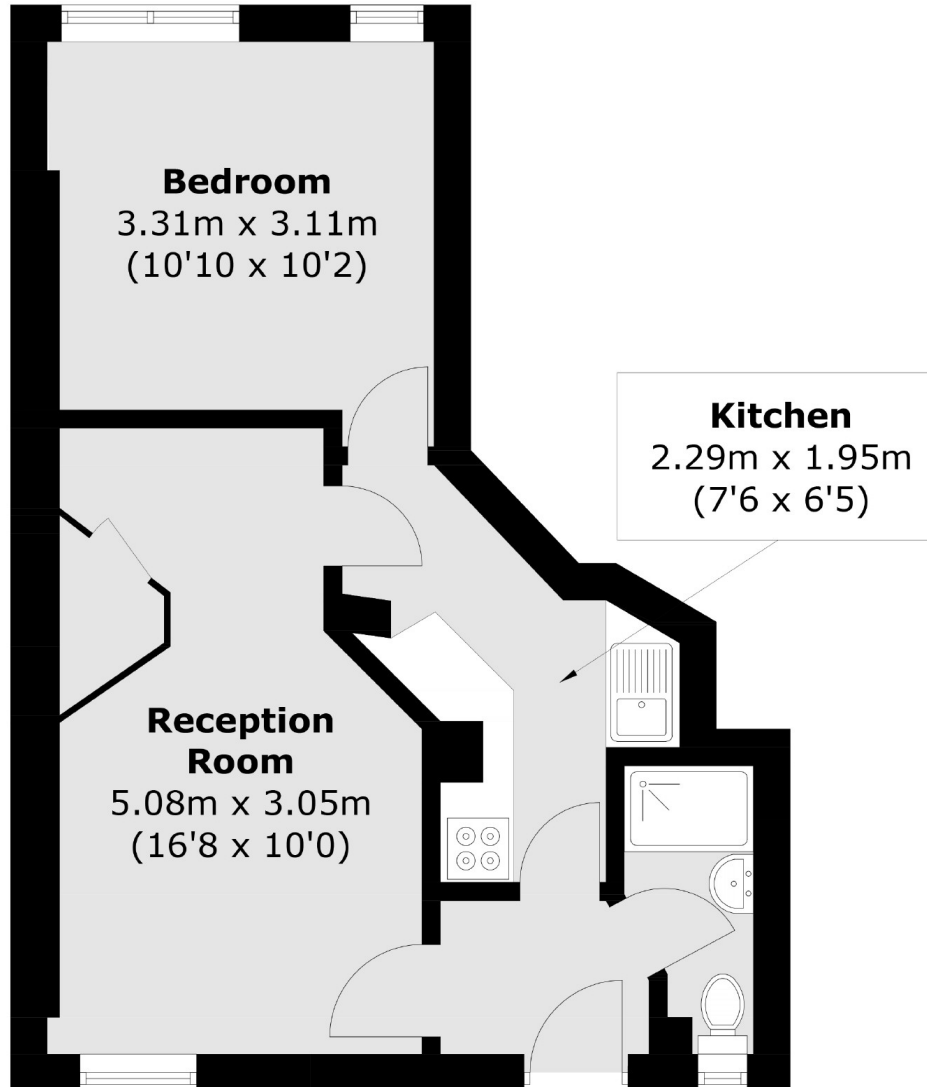

Total area (approx.): 34.7 sq. m (373.5 sq. ft)

Frank Harris & Co. Bloomsbury and Kings Cross
81 Marchmont Street,
London, WC1N 1AL
020 7405 4444
bloomsburysales@frankharris.co.uk

Energy Rating: C. We aim to make our particulars both accurate and reliable. However they are not guaranteed; nor do they form part of an offer or contract. If you require clarification on any points then please contact us, especially if you're traveling some distance to view. Please note that appliances and heating systems have not been tested and therefore no warranties can be given as to their good working order.

