

Frank Harris & Co.



Bloomsbury, WC1H

£525,000

A three-bedroom property comprising of double bedrooms, spacious reception, separate kitchen, bathroom, balcony and wood flooring throughout.

King's Cross, St Pancras International and Russell Square stations are all nearby as well as The Brunswick Centre with all its shops, restaurants and local amenities.

- Three Double Bedrooms • Private Balcony • Close to Transport •
- Low Service Charge • Quiet Location •

Frank Harris & Co.

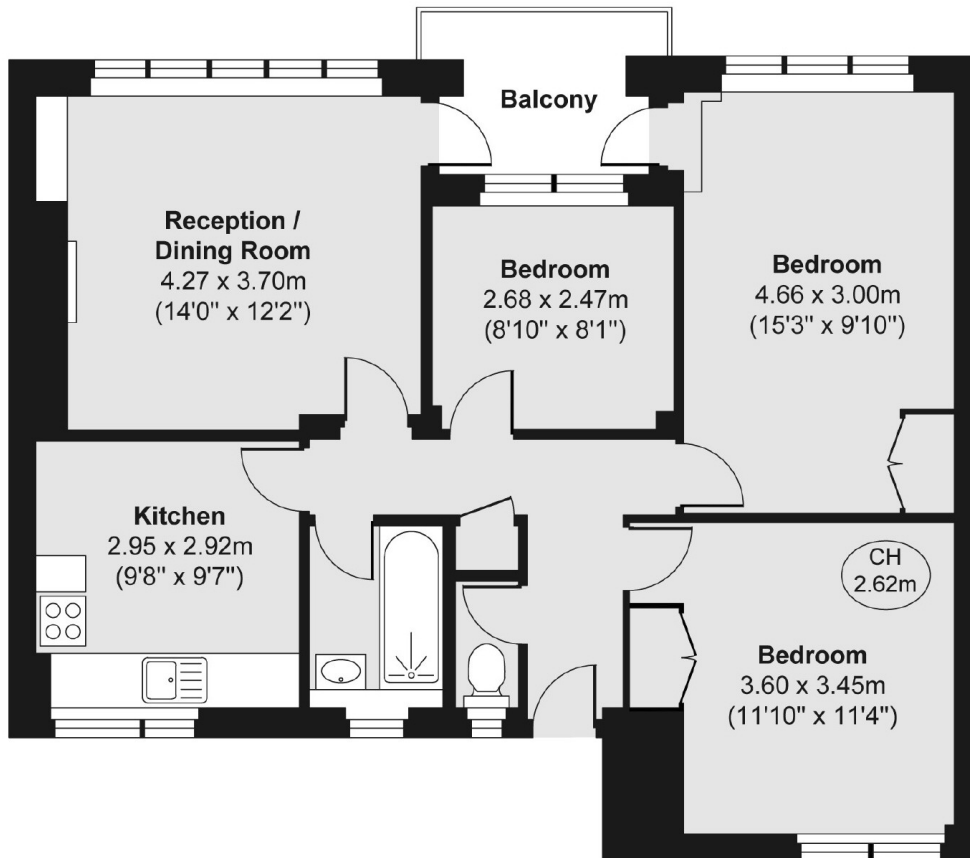

Total area (approx.) 69.93 sq. m (753 sq. ft)
Balcony area (approx.) 4.18 sq. m (45 sq. ft)

Frank Harris & Co. Bloomsbury and Kings Cross
81 Marchmont Street,
London, WC1N 1AL
020 7405 4444
bloomsburysales@frankharris.co.uk

Energy Rating: C. We aim to make our particulars both accurate and reliable. However they are not guaranteed; nor do they form part of an offer or contract. If you require clarification on any points then please contact us, especially if you're traveling some distance to view. Please note that appliances and heating systems have not been tested and therefore no warranties can be given as to their good working order.

