

Frank Harris & Co.



Bloomsbury, WC1H

£500,000

A well-presented one bedroom apartment on Judd Street, within this secure building with on-site porter. The flat is located on the 4th floor and boasts a good size lounge a double bedroom and separate kitchen.

Clare Court is located only 0.1 mile to the large Waitrose, selection of shops, restaurants, and cinema of the Brunswick Centre. It's 0.3 miles to both King's Cross Station and Russell Square Station.

- Refurbished Communal Areas • Lift Access • Furnished •
- Close to Transport • Fourth Floor • Portered building •

Frank Harris & Co.

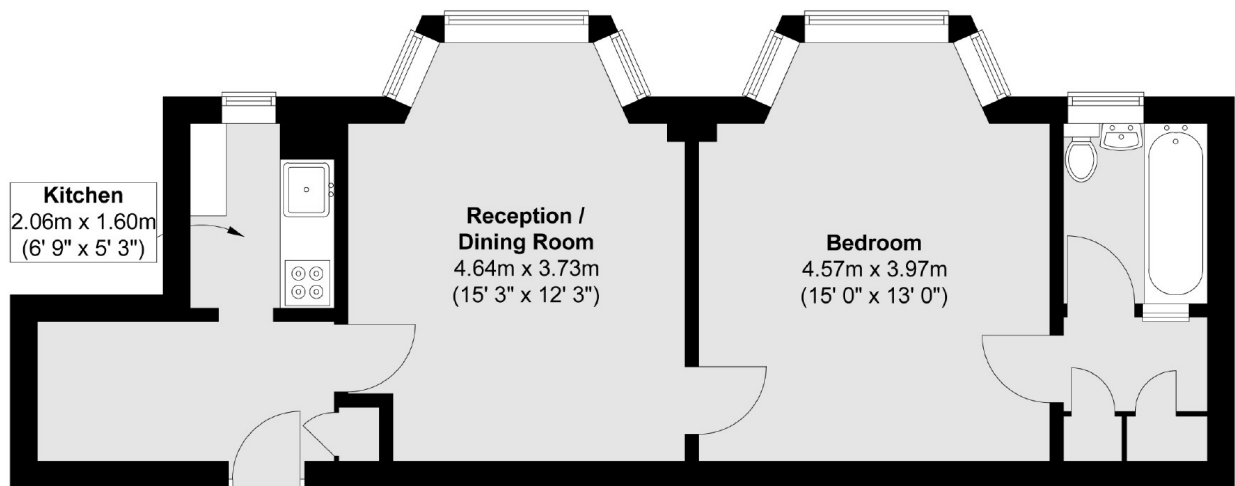

Total area (approx.) : 49 sq. m (527 sq. ft)

Frank Harris & Co. Bloomsbury and Kings Cross
81 Marchmont Street,
London, WC1N 1AL
020 7405 4444
bloomsburysales@frankharris.co.uk

Energy Rating: D. We aim to make our particulars both accurate and reliable. However they are not guaranteed; nor do they form part of an offer or contract. If you require clarification on any points then please contact us, especially if you're traveling some distance to view. Please note that appliances and heating systems have not been tested and therefore no warranties can be given as to their good working order.

