

# Frank Harris & Co.



## Killick Street, N1

£685,000

Offered to the market is this ground floor apartment located in the ideal location of N1. The property is a two bedroom, one bathroom with a modern open plan kitchen and living area. The development has fobbed and lift access. Shared Ownership Available.

Killick Street is located 0.3 miles from King's Cross St. Pancras Station which offers great transport links to central and the City of London via the Victoria, Northern, Piccadilly, Circle, Hammersmith and Metropolitan Lines. Local cafés and restaurants are a short walk away and the street is adjacent to Joseph Grimaldi Park.

• Communal Heating & Hot Water • 809 sq.ft • Two Bedroom •

# Frank Harris & Co.

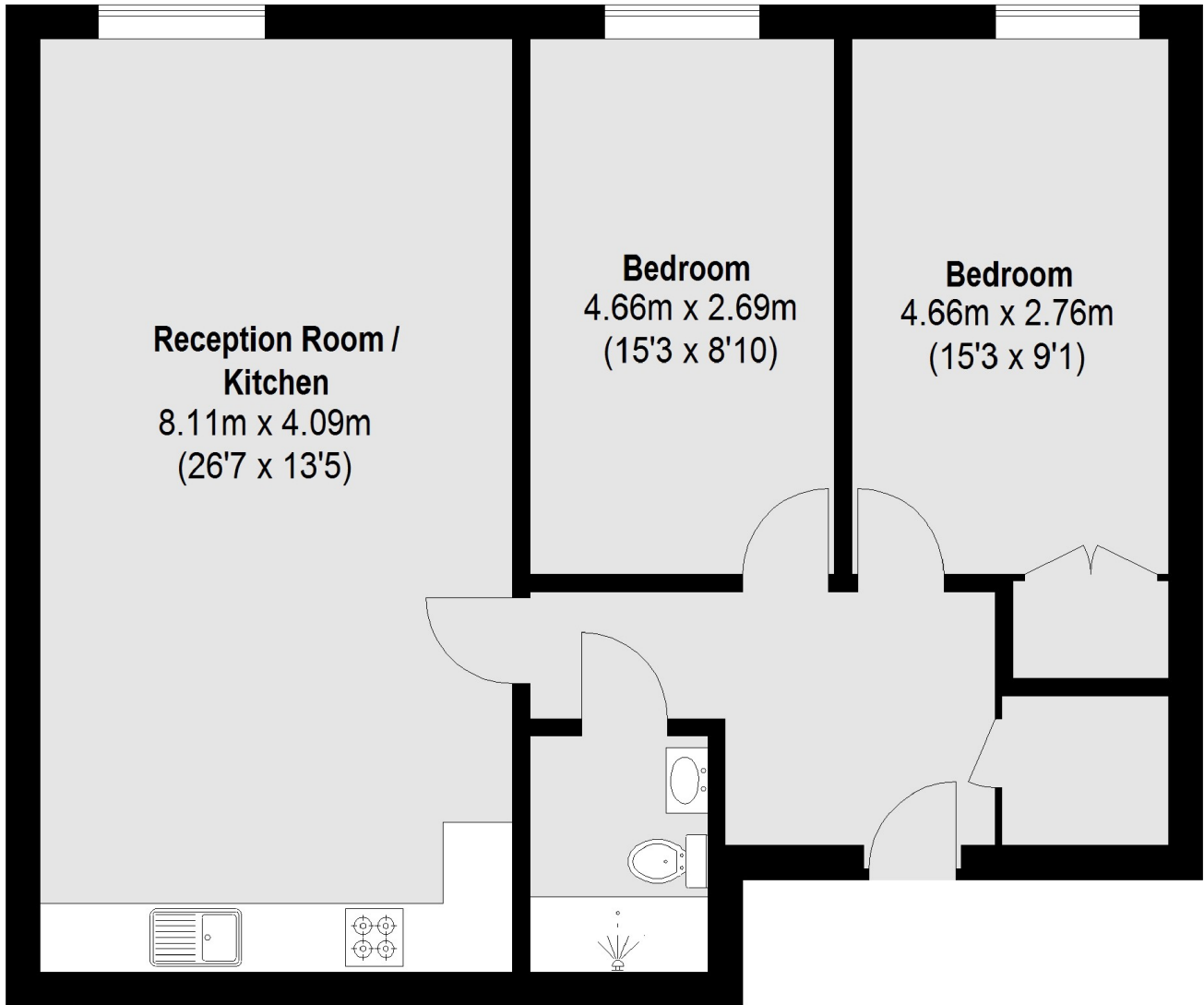

Total area (approx.): 75.15 sq. m (809 Sq. ft)

Frank Harris & Co. Bloomsbury and Kings Cross  
81 Marchmont Street,  
London, WC1N 1AL  
020 7405 4444  
[bloomsburysales@frankharris.co.uk](mailto:bloomsburysales@frankharris.co.uk)

Energy Rating: C. We aim to make our particulars both accurate and reliable. However they are not guaranteed; nor do they form part of an offer or contract. If you require clarification on any points then please contact us, especially if you're traveling some distance to view. Please note that appliances and heating systems have not been tested and therefore no warranties can be given as to their good working order.

