

Frank Harris & Co.



Fitzrovia, WC1E

£900,000

Situated on the first floor of a period building is this two double bedroom apartment. The property benefits from French doors in the reception room that lead onto a South West facing balcony with views over the communal gardens.

Gower Street is located close to Bedford Square, Oxford Street and The West End. Tottenham Court Road, Russell Square and Warren Street stations are all near by.

- Two Bedrooms • Separate Kitchen • Balcony •
- Communal Gardens • Central Location • No Onward Chain •

Frank Harris & Co.

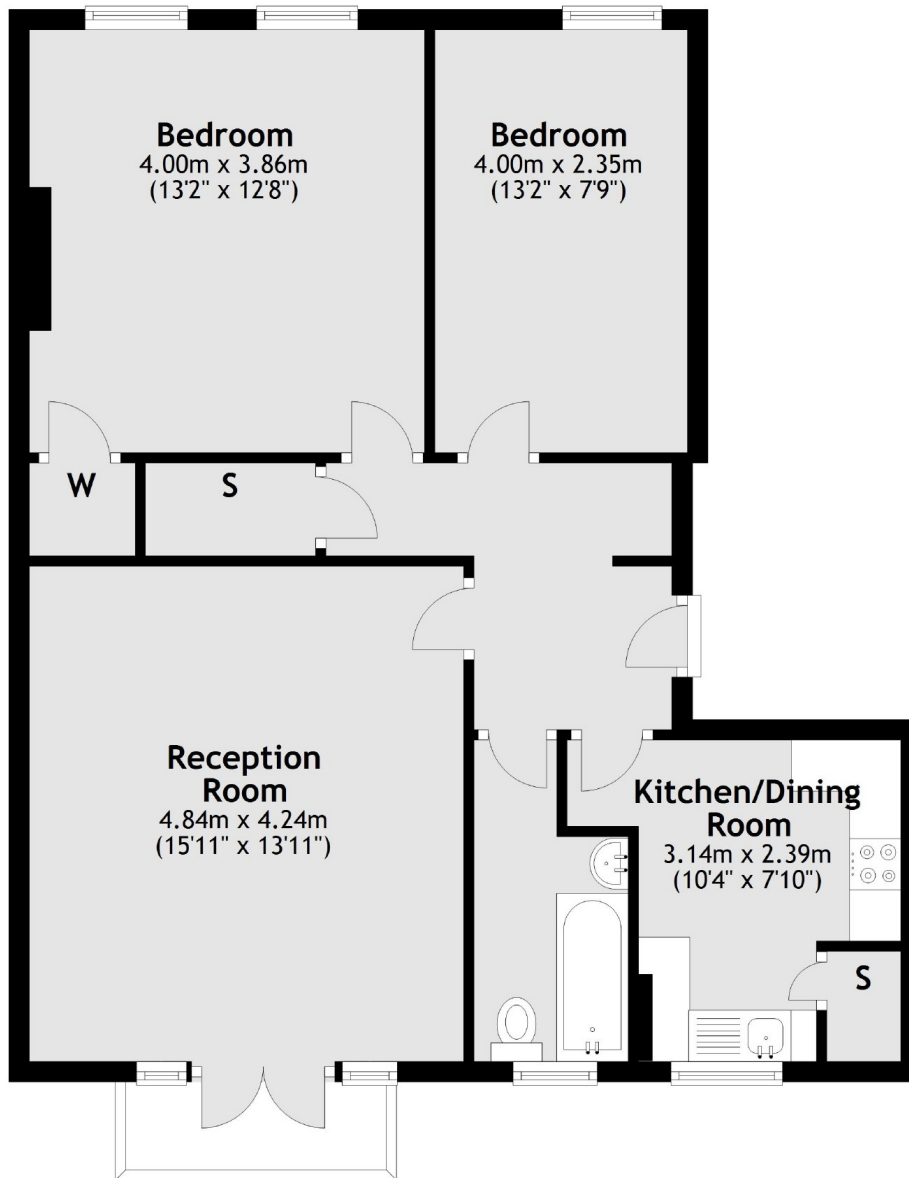

First Floor

Total area: approx. 70.9 sq. metres (762.9 sq. feet)

Frank Harris & Co. Bloomsbury and Kings Cross
81 Marchmont Street,
London, WC1N 1AL
020 7405 4444
bloomsburysales@frankharris.co.uk

Energy Rating: C. We aim to make our particulars both accurate and reliable. However they are not guaranteed; nor do they form part of an offer or contract. If you require clarification on any points then please contact us, especially if you're traveling some distance to view. Please note that appliances and heating systems have not been tested and therefore no warranties can be given as to their good working order.

