

# Frank Harris & Co.



## Sandwich House, WC1H

£550,000

OFFERS IN EXCESS OF £525,000

Located in a popular period mansion block. The property has been completely renovated throughout by its current owners and benefits from a separate kitchen, communal roof terrace, courtyard, live in caretaker and a long lease.

King's Cross and St Pancras stations are less than 5 minutes away.

- One Bedroom • Mansion Block • Central Location •
- Recently Refurbished • Fully Fitted Kitchen • Communal Roof Terrace •

# Frank Harris & Co.

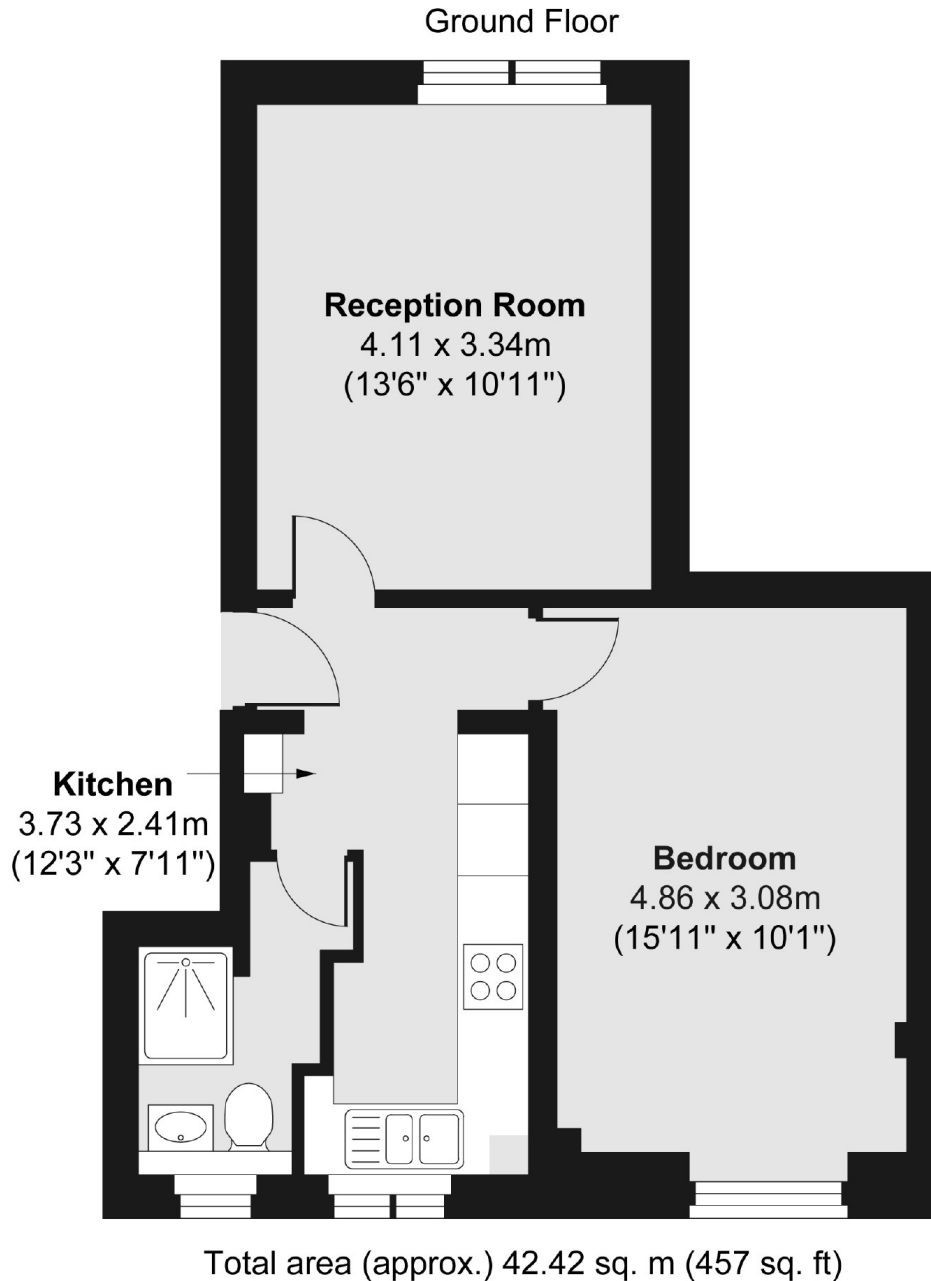

Frank Harris & Co. Bloomsbury and Kings Cross  
81 Marchmont Street,  
London, WC1N 1AL  
020 7405 4444  
bloomsburysales@frankharris.co.uk

Energy Rating: D. We aim to make our particulars both accurate and reliable. However they are not guaranteed; nor do they form part of an offer or contract. If you require clarification on any points then please contact us, especially if you're traveling some distance to view. Please note that appliances and heating systems have not been tested and therefore no warranties can be given as to their good working order.