

# Frank Harris & Co.



## Great Suffolk Street, SE1

£692 pcm

A beautiful three double bedroom apartment set within this popular development. The property is in excellent condition throughout and offered furnished, and benefits from spacious rooms and natural light.

Collinson Court is located on Great Suffolk Street, home to many bars, cafes and restaurants. It is located a short walk from Borough Station, as well as London Bridge and Elephant & Castle stations.

- Three Double Bedrooms • Separate Kitchen • Wooden Flooring •
- Furnished • Private Balcony • City Views •

# Frank Harris & Co.

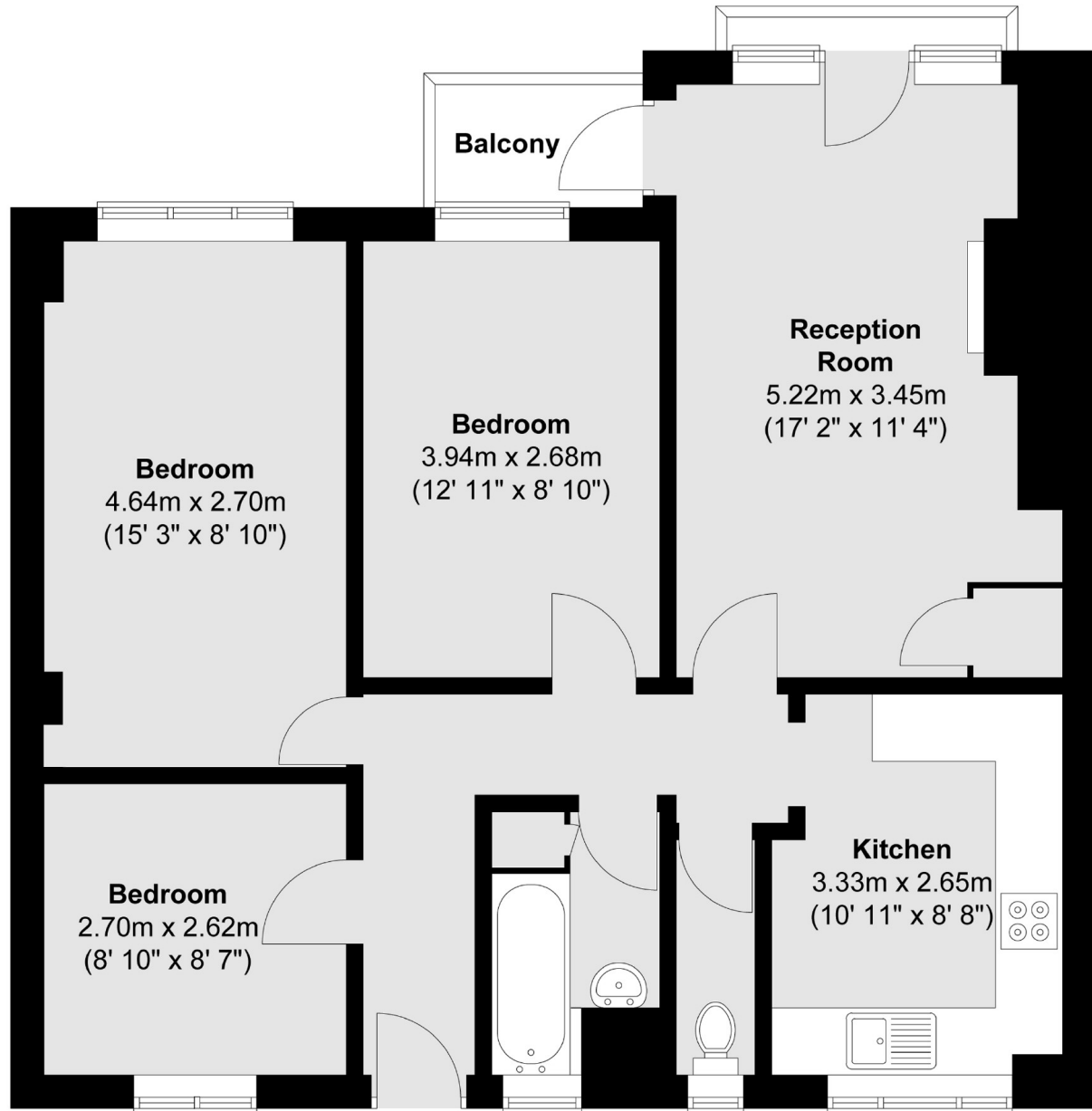

Total area (approx.) : 71.4 sq. m (768 sq. ft)  
Total balcony area (approx.) : 2.6 sq. m (28 sq. ft)

Frank Harris & Co. South Bank and Waterloo  
123 Stamford Street, London,  
SE1 9NN  
020 7590 7100  
[southbanklettings@frankharris.co.uk](mailto:southbanklettings@frankharris.co.uk)

Energy Rating: . We aim to make our particulars both accurate and reliable. However they are not guaranteed; nor do they form part of an offer or contract. If you require clarification on any points then please contact us, especially if you're traveling some distance to view. Please note that appliances and heating systems have not been tested and therefore no warranties can be given as to their good working order.

