

Frank Harris & Co.



Albert Embankment, SE1

£553 Per week

A one double bedroom property located in the prestigious Parliament View Apartments. This unit offers open plan living which leads out to a private patio area, built in wardrobes and access to an on site gym & concierge.

Albert Embankment runs along the picturesque, South Bank of the River Thames and offers uninterrupted views of the Houses of Parliament and the London Eye.

- One Bedroom • Furnished • 24hr Concierge •
- Gym Facilities • Private Patio • Built in Wardrobe •

Frank Harris & Co.

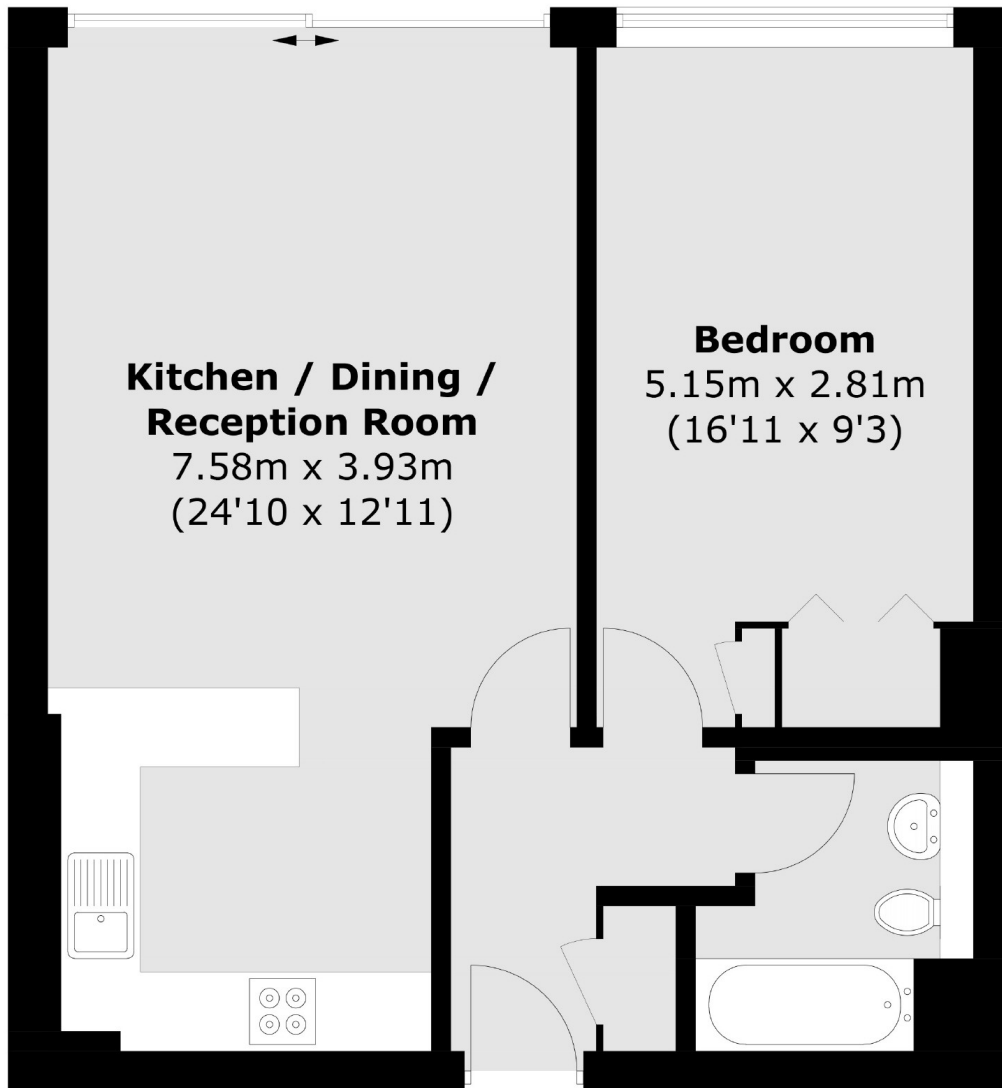

Total area (approx.): 53.9 sq. m (580.2 sq. ft)

Frank Harris & Co. South Bank and Waterloo
123 Stamford Street, London,
SE1 9NN
020 7590 7100
southbanklettings@frankharris.co.uk

Energy Rating: C. We aim to make our particulars both accurate and reliable. However they are not guaranteed; nor do they form part of an offer or contract. If you require clarification on any points then please contact us, especially if you're traveling some distance to view. Please note that appliances and heating systems have not been tested and therefore no warranties can be given as to their good working order.

