

# Frank Harris & Co.



## North Block, SE1

£500,000

A split level one bedroom flat in the sought after County Hall Complex. Set on the raised ground floor and presented in good condition the apartment has a fully fitted kitchen, spacious living room and separate dining area/study. This apartment is offered with a Share of the Freehold and an allocated off street parking space.

The flat is located a short walk from Waterloo station and benefits from a parking space within a secure car park, on-site swimming pool, gymnasium, sauna and 24hr portage.

# Frank Harris & Co.

North Block County Hall SE1  
Gross Internal Area:  
54 Sq. metres  
583 Sq. feet

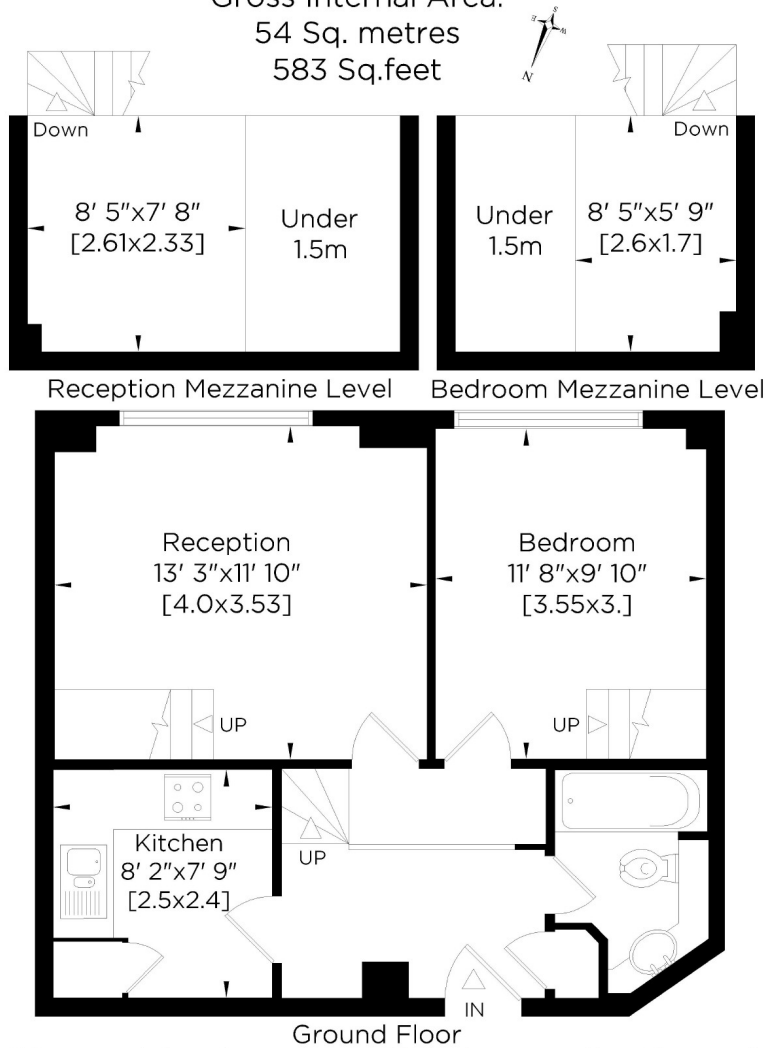

Whilst every attempt has been made to ensure the accuracy of this floor plan, measurements of doors, windows, rooms and Sq. footage are approximate within 5% accuracy. For identification purposes only. Walls with small angles drawn Straight. Not to be used as part of the decision to buy. You must recheck all details before purchase and only purchase when you have confirmed them. No appliances tested. Not to scale. © - www.steele.london - Email: patricia@steele.london - Tel: 07847 219401

Frank Harris & Co. South Bank and Waterloo  
123 Stamford Street, London,  
SE1 9NN  
020 7620 3400  
southbanksales@frankharris.co.uk

Energy Rating: C. We aim to make our particulars both accurate and reliable. However they are not guaranteed; nor do they form part of an offer or contract. If you require clarification on any points then please contact us, especially if you're traveling some distance to view. Please note that appliances and heating systems have not been tested and therefore no warranties can be given as to their good working order.

