

# Frank Harris

— & Co. —



## South Block, Belvedere Road, SE1

£750,000

A lovely two bedroom flat in an iconic building on the South Bank. With two double bedrooms, a modern kitchen with cream cabinets, an en-suite bathroom and shower room. Within a short walk of The Houses of Parliament, The London Eye and the many bars and restaurants in the area. The local area is vibrant with The Young and Old Vic theatres, just a short walk away, along with the National Theatre, Royal Festival Hall and the South Bank Centre. Long lease.



County Hall offers leisure facilities including a gym and swimming pool, spa and communal courtyard gardens, along with a 24 hour concierge service.

A short walk to Waterloo Station with access to the Jubilee, Northern and Bakerloo line, along with the Waterloo and City line and National Rail. Westminster station along with many bus routes nearby.

- Two Bedroom Apartment • Parking Space • Long Lease •
- Leisure Facilities • No Onward Chain • 24 Hour Concierge •





# Frank Harris

## & Co.

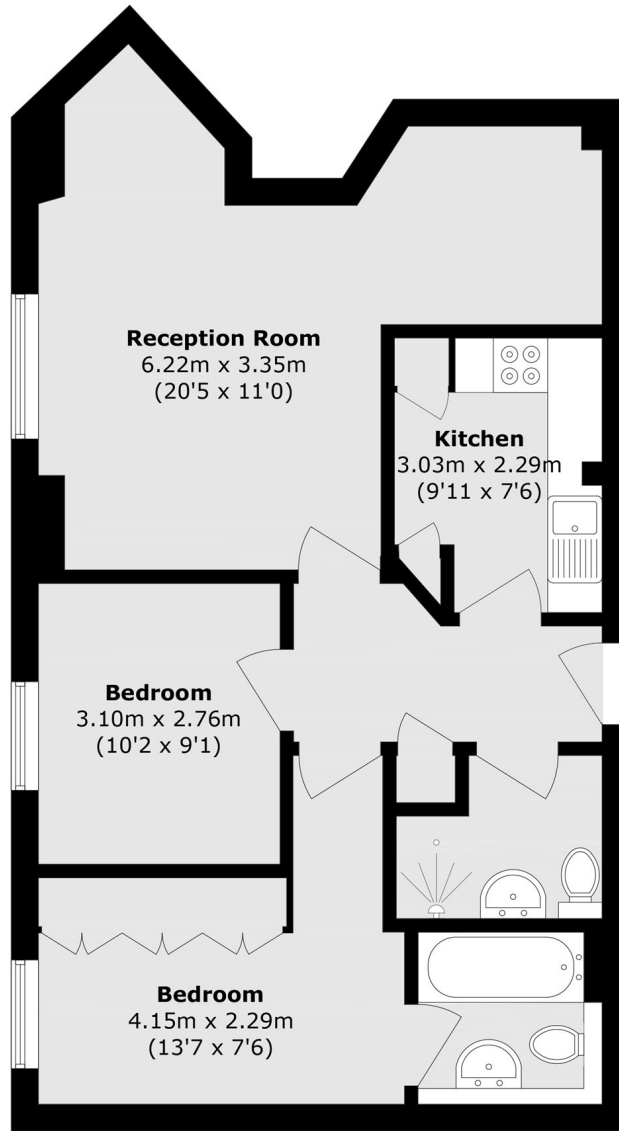

Total area (approx.): 66.4 sq. m (714.7 sq. ft)

Frank Harris & Co. Barbican and City  
87 Long Lane, London,  
EC1A 9ET  
020 7600 7000  
citysales@frankharris.co.uk

Energy Rating: C. We aim to make our particulars both accurate and reliable. However they are not guaranteed; nor do they form part of an offer or contract. If you require clarification on any points then please contact us, especially if you're traveling some distance to view. Please note that appliances and heating systems have not been tested and therefore no warranties can be given as to their good working order.

