

Frank Harris & Co.



Lamb's Passage, City of London, EC1Y

£120,000

A modern, purpose built one bedroom apartment, located in a historical part of London, between Smithfield Market, The Barbican and The City of London. The property has recently been refurbished, including a fully tiled bathroom with a large shower, engineered oak flooring, modern kitchen, study area, bespoke fitted wardrobes, recently decorated throughout. Shared Ownership.



Lamb's Passage is a short walk away from the bars and restaurants of Clerkenwell and Shoreditch.

The Museum of London will open in 2026, expecting to attract over one million visitors annually, the 900 year old Smithfield meat market will be also relocating from 2028.

St Bartholomew the Great, London's oldest surviving church is also just a short walk away.

One New Change shopping centre is close by at St.Pauls, and there is a full size Waitrose supermarket on Whitecross Street alongside a Marks and Spencer Food and clothing store in Moorgate.

Within walking distance of Barbican and Moorgate station, with access to the Elizabeth Line, Hammersmith and City line, Circle, Metropolitan and Northern lines.

- One Bedroom Flat • Shared Ownership • Wooden Floors •
- Top Floor (5th) • EWS1 Compliant • City Location •



Frank Harris & Co.

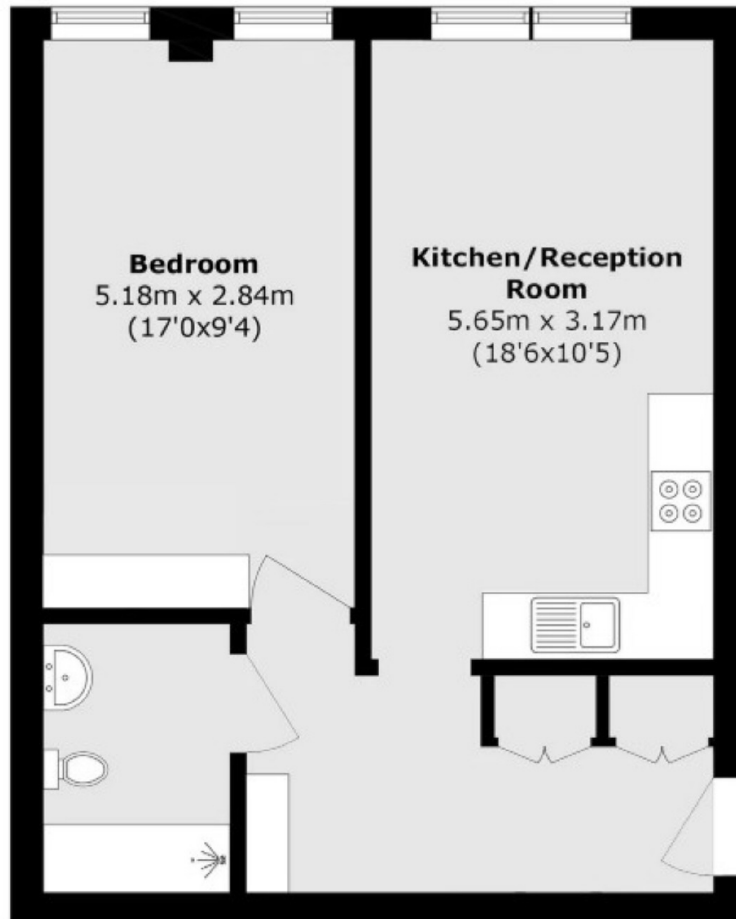

Total area (approx.): 47.5 sq. m (511.3 sq. ft)

Frank Harris & Co. Barbican and City
87 Long Lane, London,
EC1A 9ET
020 7600 7000
citysales@frankharris.co.uk

Energy Rating: B. We aim to make our particulars both accurate and reliable. However they are not guaranteed; nor do they form part of an offer or contract. If you require clarification on any points then please contact us, especially if you're traveling some distance to view. Please note that appliances and heating systems have not been tested and therefore no warranties can be given as to their good working order.

