

Frank Harris & Co.



, EC1A

£600 Per week

A bright and spacious one bedroom flat set within a conservation area in the heart of the City of London. There is a large reception room, brand new kitchen and a terrace. The bedroom has built-in wardrobes and storage, with an en suite shower / WC. There's also a separate WC off the hallway, and hardwood and engineered wood flooring throughout.



The location benefits from superb transport links, with Barbican, Farringdon and St Paul's stations all being close by. Thameslink services from Farringdon give direct access to Gatwick and Luton airports, and the Elizabeth line direct, fast access to Canary Wharf, Heathrow and Bond Street.

- One Bedroom Flat • Patio Garden Area • Newly Fitted Kitchen •
- Shower Room • Quiet Location •



Frank Harris & Co.

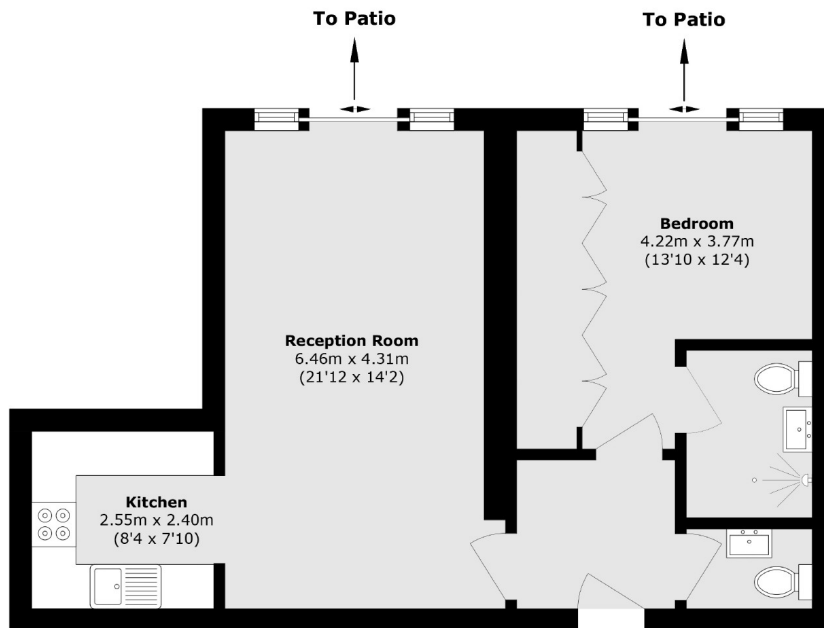

Total area (approx.): 57.5 sq. m (618.9 sq. ft)

Frank Harris & Co. Barbican and City
87 Long Lane, London,
EC1A 9ET
020 7601 1919
citylettings@frankharris.co.uk

Energy Rating: C. We aim to make our particulars both accurate and reliable. However they are not guaranteed; nor do they form part of an offer or contract. If you require clarification on any points then please contact us, especially if you're traveling some distance to view. Please note that appliances and heating systems have not been tested and therefore no warranties can be given as to their good working order.

