

# Frank Harris — & Co. —



## Breton House, Barbican, EC2Y

£500,000

A large studio flat, with the original Brooke Marine kitchen and fully tiled bathroom. There is a Hulsta room divider along with matching furniture and a fitted wallbed which will remain. With an east aspect which benefits from the morning sun, there are full height windows and a sliding door leading to the balcony/ fire exit.



Residents benefit from use of the communal gardens, parking, bike storage and storage cages below the building (available by separate negotiation with the Corporation of London), there is 24 hour portorage in the car parks.

There are three cinema screens on the estate along with a library, arts centre, restaurants and conservatory.

Amenities nearby include a full size Waitrose, a good range of restaurants and the Barbican cinema. Transport links include Moorgate, Barbican, and Farringdon with access to the Elizabeth line, Hammersmith and City line, Circle, District, Metropolitan and Thameslink.

- Studio Flat • Type F2A • Third Floor •
- East Aspect • Fitted Wallbed • No Onward Chain •





# Frank Harris & Co.

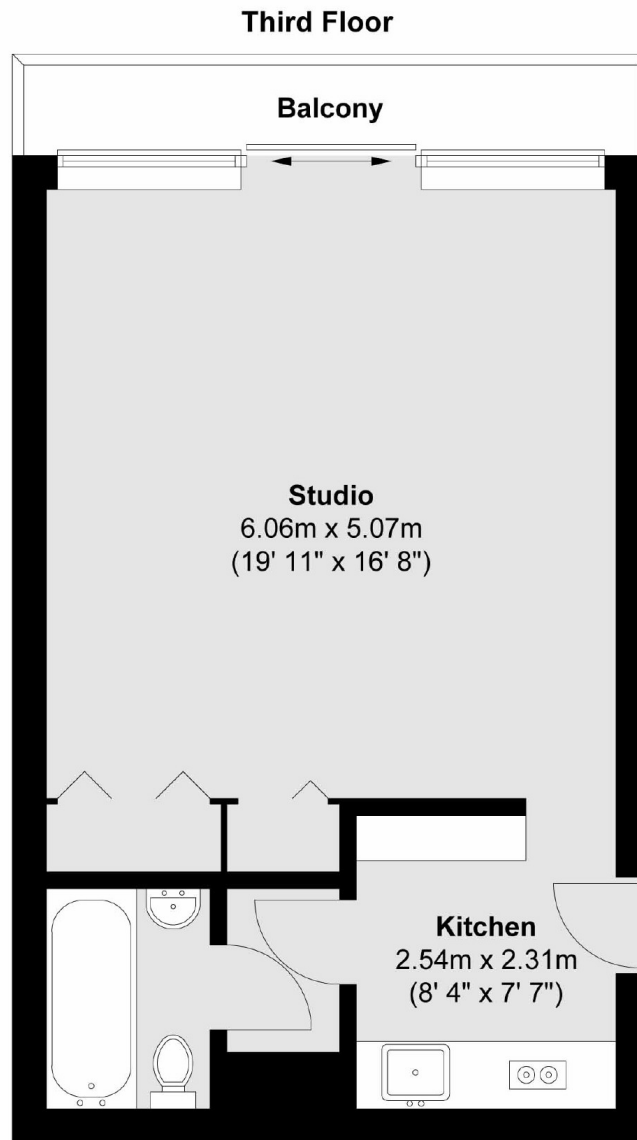

Total area (approx.) : 41.6 sq. m (448 sq. ft)  
Total balcony area (approx.) : 4.3 sq. m (46 sq. ft)

Frank Harris & Co. Barbican and City  
87 Long Lane, London,  
EC1A 9ET  
020 7600 7000  
citysales@frankharris.co.uk

Energy Rating: N/A. We aim to make our particulars both accurate and reliable. However they are not guaranteed; nor do they form part of an offer or contract. If you require clarification on any points then please contact us, especially if you're traveling some distance to view. Please note that appliances and heating systems have not been tested and therefore no warranties can be given as to their good working order.

