

Frank Harris

— & Co. —



Bartholomew Close, City of London, EC1A

£615,000

A bright one bedroom flat set within a conservation area in the heart of the City of London. There is a good sized reception room, newly fitted kitchen, bedroom with fitted cupboards, modern shower room, separate wc and hardwood flooring. The reception room has a wall of windows and door leading to a large patio.

The location benefits from superb transport links, with Barbican, Farringdon and St Paul's stations all being close by. Thameslink services from Farringdon give direct access to Gatwick and Luton airports, and the Elizabeth line direct, fast access to Canary Wharf, Heathrow and Bond Street.

- One Bedroom Flat • Patio Garden Area • Newly Fitted Kitchen •
- Shower Room • Quiet Location • No Onward Chain •

Frank Harris & Co.

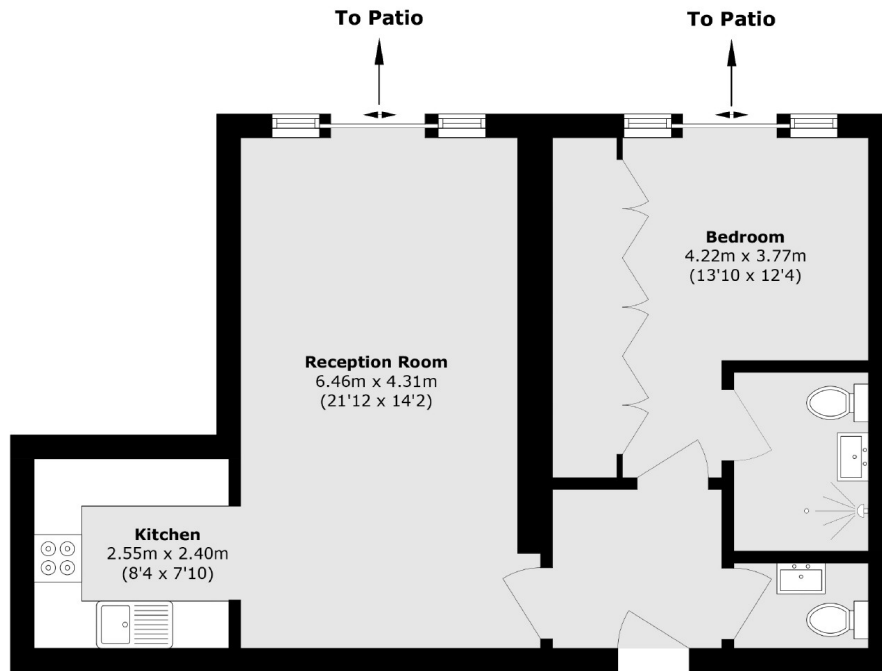

Total area (approx.): 57.5 sq. m (618.9 sq. ft)

Frank Harris & Co. Barbican and City
87 Long Lane, London,
EC1A 9ET
020 7600 7000
citysales@frankharris.co.uk

Energy Rating: C. We aim to make our particulars both accurate and reliable. However they are not guaranteed; nor do they form part of an offer or contract. If you require clarification on any points then please contact us, especially if you're traveling some distance to view. Please note that appliances and heating systems have not been tested and therefore no warranties can be given as to their good working order.

