

# Frank Harris & Co.



## Lowden Court, Prestwood Street, N1

£1,050,000

A good sized three bedroom apartment situated on the top floor (approx 91 sqmt, 988 sqft), with a large bathroom, separate wc, contemporary kitchen with Siemens appliances open plan to the reception room with a balcony overlooking Shepherdess Walk Park. Residents have use of a basement storage room for bikes and the use of a limited number of parking spaces.



Lowden Court offers a fantastic opportunity to reside in a contemporary and well-maintained development. This stylish property is situated in the vibrant area of Islington, within easy reach of excellent transport links, making it an ideal choice for both professionals and families.

The property features a spacious and airy open-plan living area, perfect for modern living and entertaining. Large windows allow natural light to flood the space, creating a bright and welcoming atmosphere. The kitchen is fully fitted with high-quality appliances, offering ample storage and preparation space. The accommodation includes generously sized bedrooms, each designed with comfort in mind, and a well-appointed family bathroom with sleek, modern fixtures. Residents also benefit from well-kept communal spaces and secure entry, ensuring peace of mind.

Lowden Court is ideally located for easy access to local amenities, including a variety of shops, cafes, and restaurants. It is an exceptional choice for those seeking convenience, style, and comfort in one of London's most sought-after areas.

Situated in a quiet location, within walking distance of Wenlock Basin and the shopping facilities in Islington.

Nearby transport options, include Angel Station (Northern Line) and Highbury & Islington Station (Victoria and Overground Lines), offer excellent connections to the rest of London. Perfectly positioned for both city living and relaxation.

- Top Floor Apartment • Three Bedrooms • Overlooking A Park •
  - Large Balcony • Lift Access • Contemporary Kitchen •
-





# Frank Harris

## & Co.

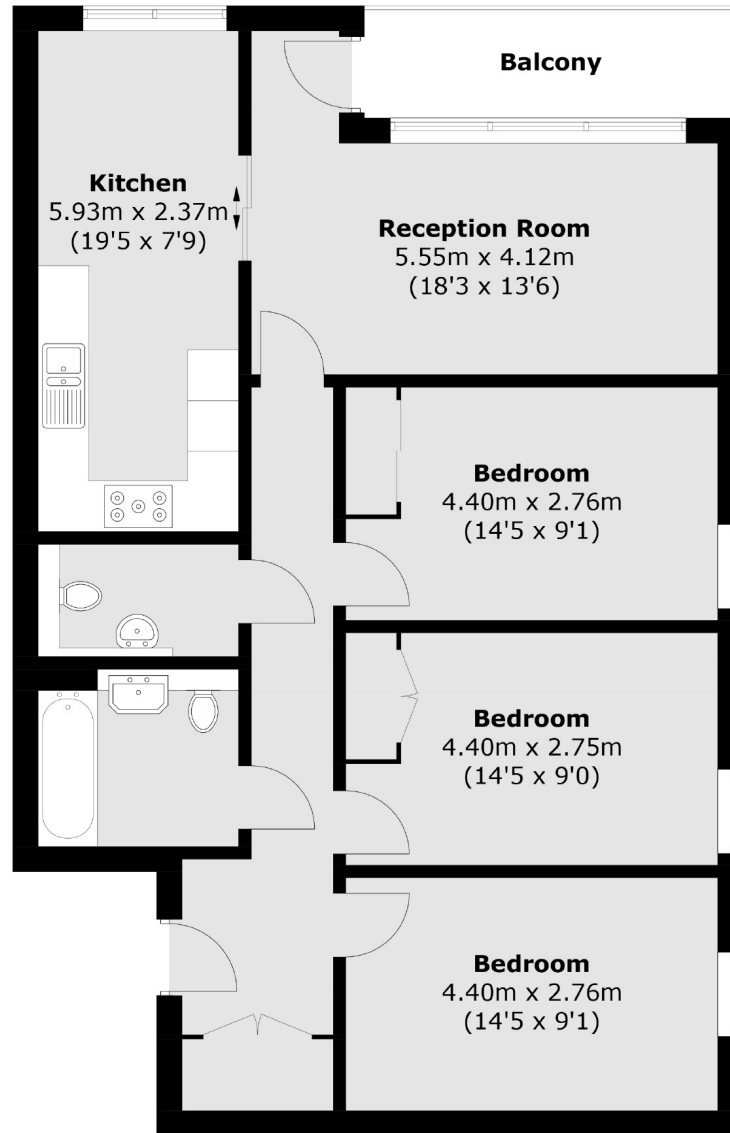

Total area (approx.): 91.8 sq. m (988.1 sq. ft)  
Balcony area (approx.): 5.7 sq. m (61.3 sq. ft)

Frank Harris & Co. Barbican and City  
87 Long Lane, London,  
EC1A 9ET  
020 7600 7000  
citysales@frankharris.co.uk

Energy Rating: B. We aim to make our particulars both accurate and reliable. However they are not guaranteed; nor do they form part of an offer or contract. If you require clarification on any points then please contact us, especially if you're traveling some distance to view. Please note that appliances and heating systems have not been tested and therefore no warranties can be given as to their good working order.

