

Frank Harris

— & Co. —



Florin Court, EC1M

£255,000

A bright studio flat on the ninth floor at the rear of this Grade II Listed building. The studio room has ample space for a bed and seating area, with a lovely open aspect facing east. The kitchenette has fitted cabinets, a freestanding microwave, fridge and hob. The bathroom is fully tiled with a bath and fitted shower, wash basin, wc, heated towel rail and is fully tiled.



Florin Court is a 1930's Art Deco style building on Charterhouse Square, facilities include a roof terrace with seating and views across the Square and rooftops of the area, a basement swimming pool, gym, sauna and yoga room. There is also a launderette with washing machines and tumble dryers (small fee applies).

Across the square is The Charterhouse, a former Carthusian monastery.. The local area is being regenerated with the Museum of London relocating to Smithfield market in 2025.

Within walking distance of Farringdon station (Elizabeth line), Barbican and Clerkenwell with its excellent bars and restaurants.

- Studio Apartment • 9th Floor • Communal Roof Terrace •
 - Swimming Pool • Basement Gym • No Onward Chain •
-



Frank Harris & Co.

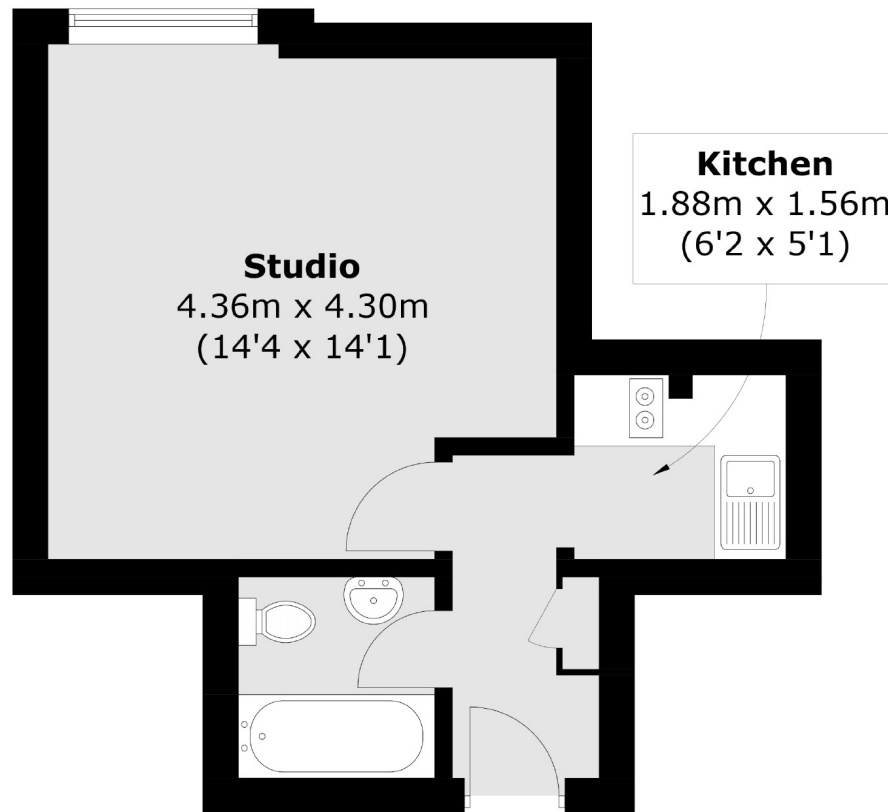

Total area (approx.): 27.3 sq. m (293.8 sq. ft)

Frank Harris & Co. Barbican and City
87 Long Lane, London,
EC1A 9ET
020 7600 7000
citysales@frankharris.co.uk

Energy Rating: D. We aim to make our particulars both accurate and reliable. However they are not guaranteed; nor do they form part of an offer or contract. If you require clarification on any points then please contact us, especially if you're traveling some distance to view. Please note that appliances and heating systems have not been tested and therefore no warranties can be given as to their good working order.

