

Frank Harris & Co.



City of London, EC1A

£525 Per week

A top floor one bedroom apartment offered on a part-furnished basis and available immediately. This development is located on a quiet side street between Smithfield and St. Paul's and has a daytime concierge.



Spencer Heights is located about a quarter mile walk to Barbican Underground station.

- One bedroom • Part- Furnished • Top floor flat •
- South Aspect • Communal Roof Terrace • Portered Building •



Frank Harris & Co.

Eighth Floor

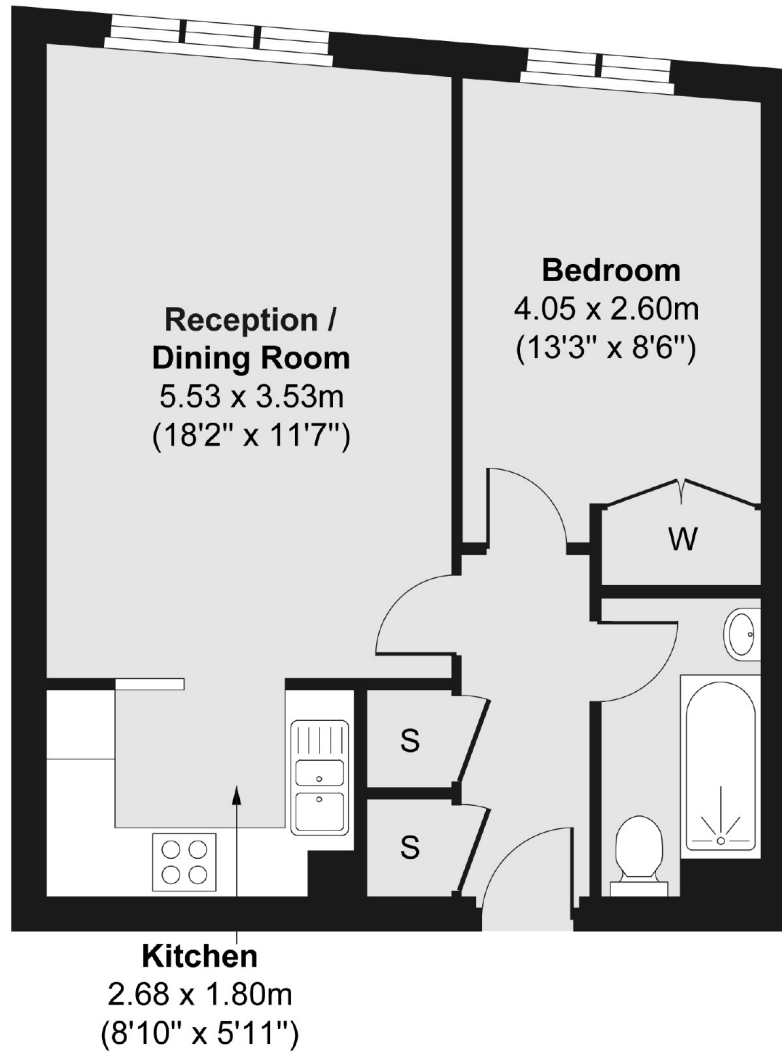

Total area (approx.) 44.71 sq. m (481 sq. ft)

Frank Harris & Co. Barbican and City
87 Long Lane, London,
EC1A 9ET
020 7601 1919
citylettings@frankharris.co.uk

Energy Rating: C. We aim to make our particulars both accurate and reliable. However they are not guaranteed; nor do they form part of an offer or contract. If you require clarification on any points then please contact us, especially if you're traveling some distance to view. Please note that appliances and heating systems have not been tested and therefore no warranties can be given as to their good working order.

