

Frank Harris & Co.



London House, EC1A

£475,000

A one bedroom flat situated on the 8th floor, presented in immaculate order. Residents have use of a communal roof terrace. Sitting at the front of the building benefitting from the morning sun and a balcony leading from the reception room. The kitchen has wooden style cabinets and integrated appliances, the bedroom has a fitted wardrobe and also faces east. Long lease, Share of Freehold

London House is located in the middle of the City, between St. Paul's and Barbican stations. Other nearby stations include City Thameslink and Farringdon.

- One Bedroom Flat • 8th Floor • East Aspect •

Frank Harris & Co.

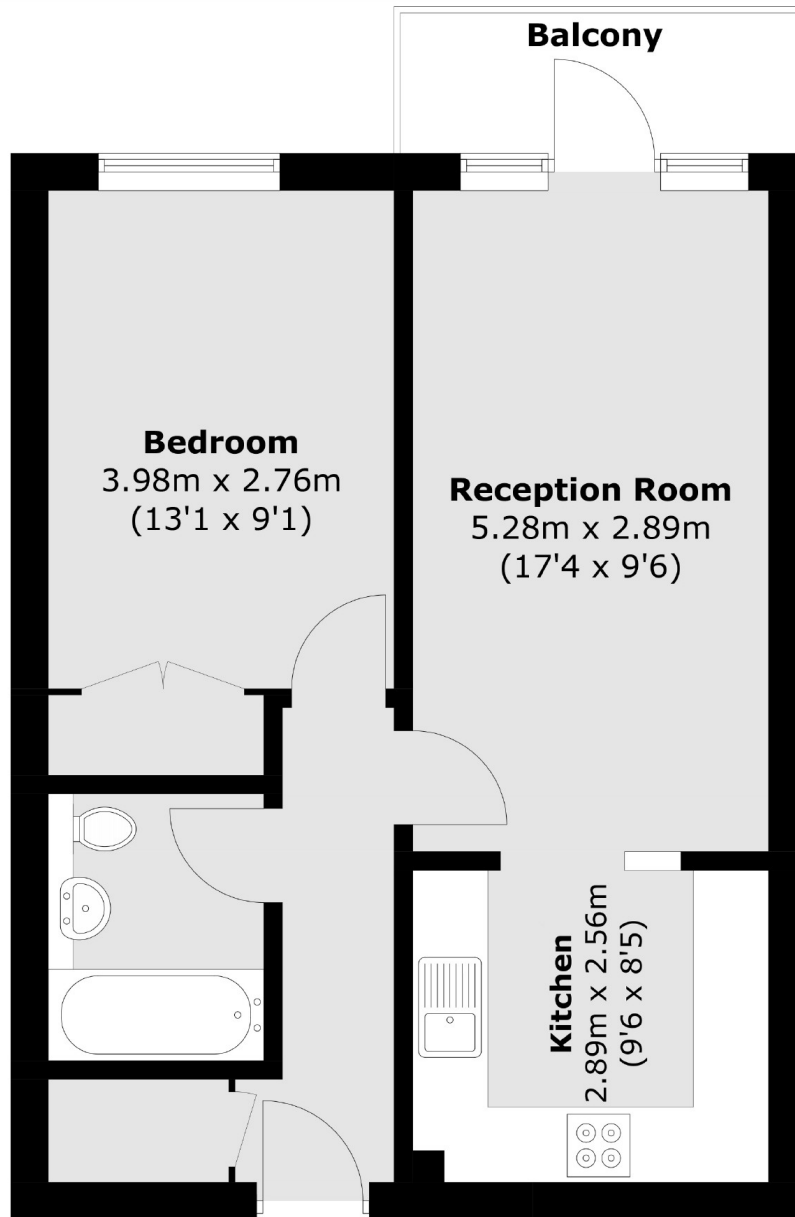

Total area (approx.): 45.8 sq. m (493.0 sq. ft)
Balcony : 3.5 sq. m (37.7 sq. ft)

Frank Harris & Co. Barbican and City
87 Long Lane, London,
EC1A 9ET
020 7600 7000
citysales@frankharris.co.uk

Energy Rating: C. We aim to make our particulars both accurate and reliable. However they are not guaranteed; nor do they form part of an offer or contract. If you require clarification on any points then please contact us, especially if you're traveling some distance to view. Please note that appliances and heating systems have not been tested and therefore no warranties can be given as to their good working order.

