

# Frank Harris & Co.



Moorgate, EC1Y

£750 Per week

A modern two bedroom, two bathroom apartment with a large west facing balcony overlooking the grounds of the HAC. The flat has a well-appointed interior with high quality fixtures and fittings throughout.



The Westview Apartments building is just off Finsbury Square in the City of London, close to many local transport links including Liverpool Street, Moorgate and Old Street (all about 1/4 mile away).

- Two Bedrooms • Two Bathrooms • Climate Control AC/Heating •
- Wood Floors • Large Balcony • Spectacular Views •



# Frank Harris & Co.

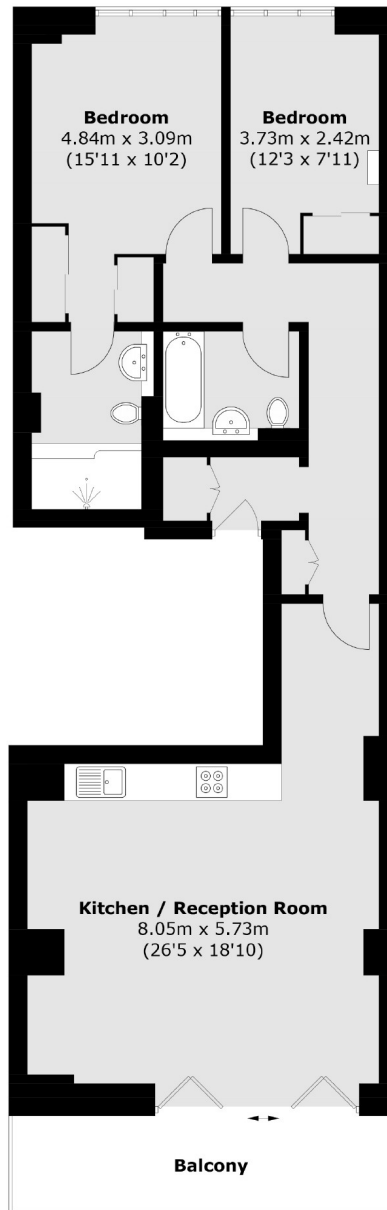

Total area (approx.): 84.0 sq. m (904.2 sq. ft)  
Balcony area : 9.7 sq. m (104.4 sq. ft)

Frank Harris & Co. Barbican and City  
87 Long Lane, London,  
EC1A 9ET  
020 7601 1919  
citylettings@frankharris.co.uk

Energy Rating: B. We aim to make our particulars both accurate and reliable. However they are not guaranteed; nor do they form part of an offer or contract. If you require clarification on any points then please contact us, especially if you're traveling some distance to view. Please note that appliances and heating systems have not been tested and therefore no warranties can be given as to their good working order.

