

Frank Harris & Co.



Wormwood Street, City of London, EC2M

£799,500

A bright two bedroom apartment in a small block close to Liverpool Street station and Spitalfields, with a dual aspect reception room overlooking St Botolph gardens, two double bedrooms and a bathroom. The property has recently been upgraded throughout and has a lease in excess of 970 years.

Excellent location, close to Liverpool Street station with access to mainline and tube, including the Elizabeth line, Central, Circle Hammersmith and City and Metropolitan line.

- Two bedrooms • Third Floor • 972 year lease •
- Contemporary kitchen • Close to Liverpool St • No onward chain •

Frank Harris & Co.

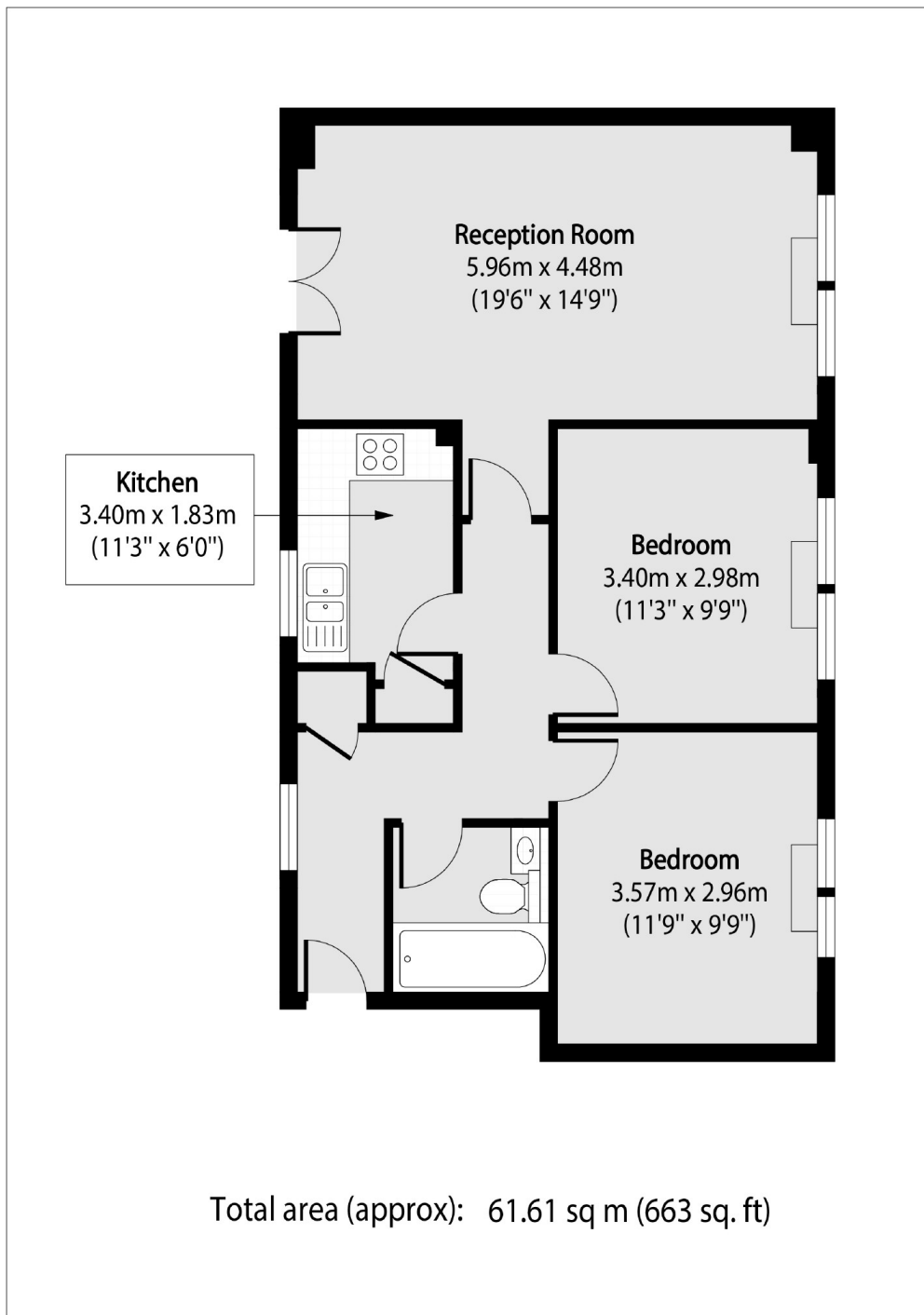

Frank Harris & Co. Barbican and City
87 Long Lane, London,
EC1A 9ET
020 7600 7000
citysales@frankharris.co.uk

Energy Rating: . We aim to make our particulars both accurate and reliable. However they are not guaranteed; nor do they form part of an offer or contract. If you require clarification on any points then please contact us, especially if you're traveling some distance to view. Please note that appliances and heating systems have not been tested and therefore no warranties can be given as to their good working order.

